

15 – Frames and Sheathings

Weldment CD Housing

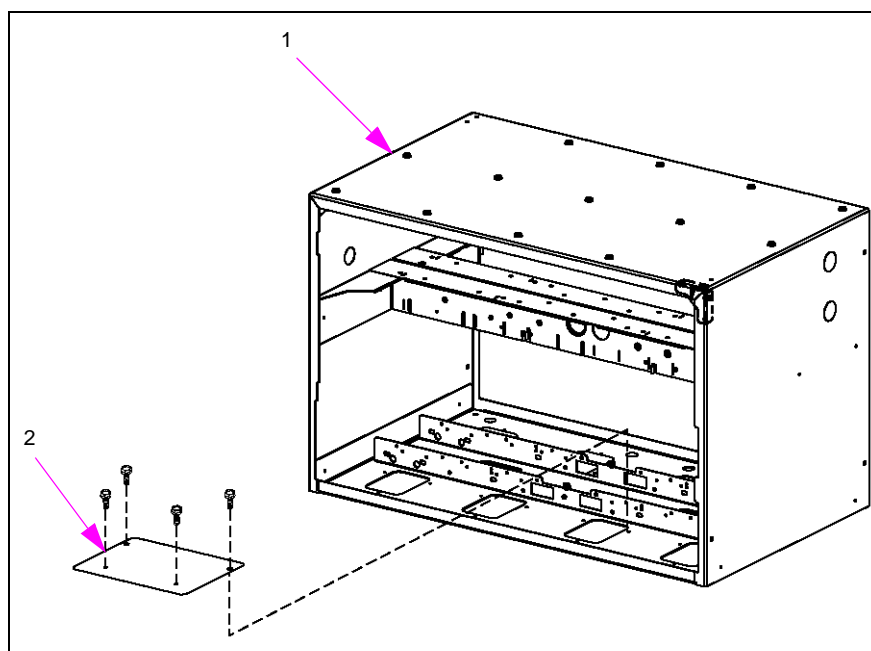

| Item # | Description | Current Part | Previous Part | Quantity |
|--|------------------------------------|--------------|---------------|----------|
| 1 | Weldment CD Housing | M02959A002 | M02959A001 | 1 |
| 2 | Upper Manifold Blanking Plate | M02961B001 | - | 1 |
| | • Screw, Metric M5 X 10 (see note) | - | - | 4 |
| Note: Use Metric Hardware Kit [K96620-01 (includes screws, nuts, bolts)] to replace fasteners. | | | | |

CD Module with Lower Rail - Ecometer and Encore 550 SMART Meter

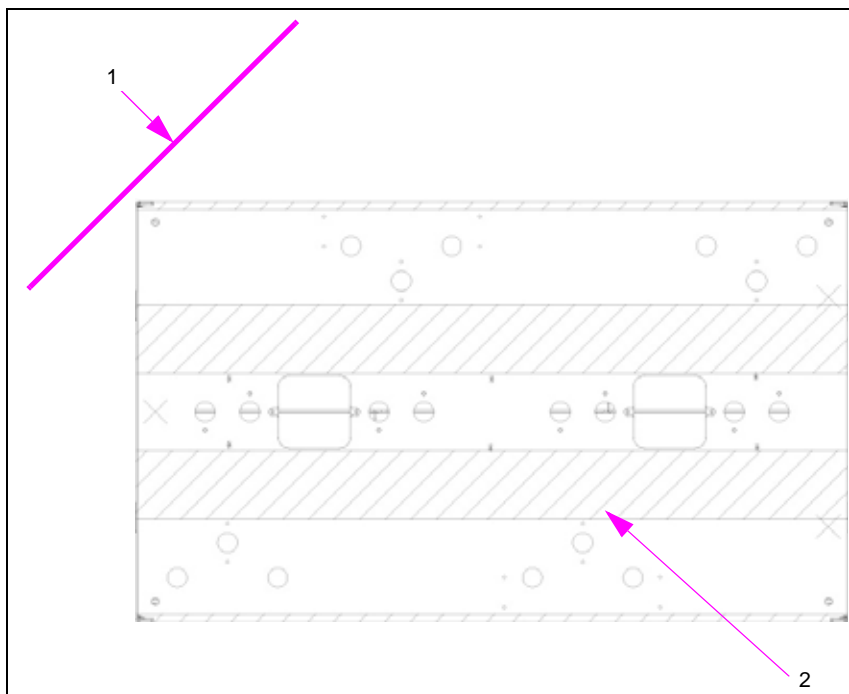

| Item # | Description | Current Part | Previous Part | Quantity |
|--------|-----------------------------|--------------|--------------------------|----------|
| 1 | CD Module Assembly | M03122A003 | M03122A002 M03122A001 | 1 |
| 2 | Center Lower C Channel Rail | M03488B002 | M03488B001 | 1 |
| - | CD Module Top Cover | M05717B001 | - | 1 |

CD Module - Ecometer Option

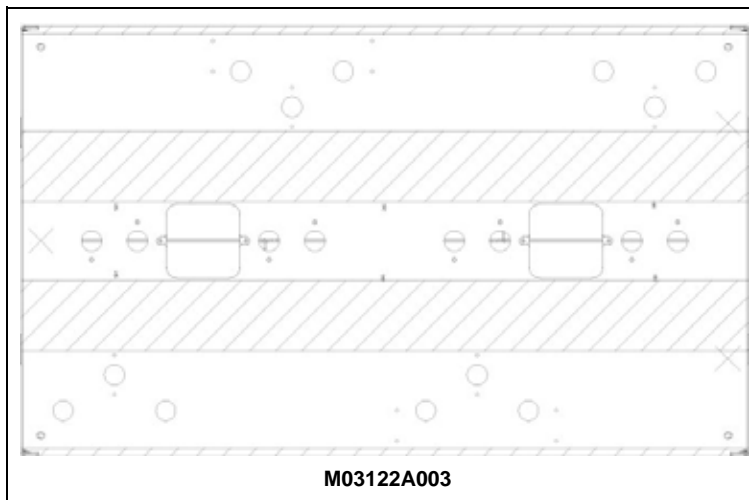

| Item # | Description | Current Part | Quantity |
|---|----------------------------------|--------------|----------|
| 1 | CD Module Assembly (see note) | M03122A003 | 1 |
| <i>Note: This part is in Encore 550 units with SMART Meter.</i> | | | |

CD Module with Lower Rail - Encore S Series

Note: Housing, CD Lower Frame M03122A002 has been replaced by M03122A003.

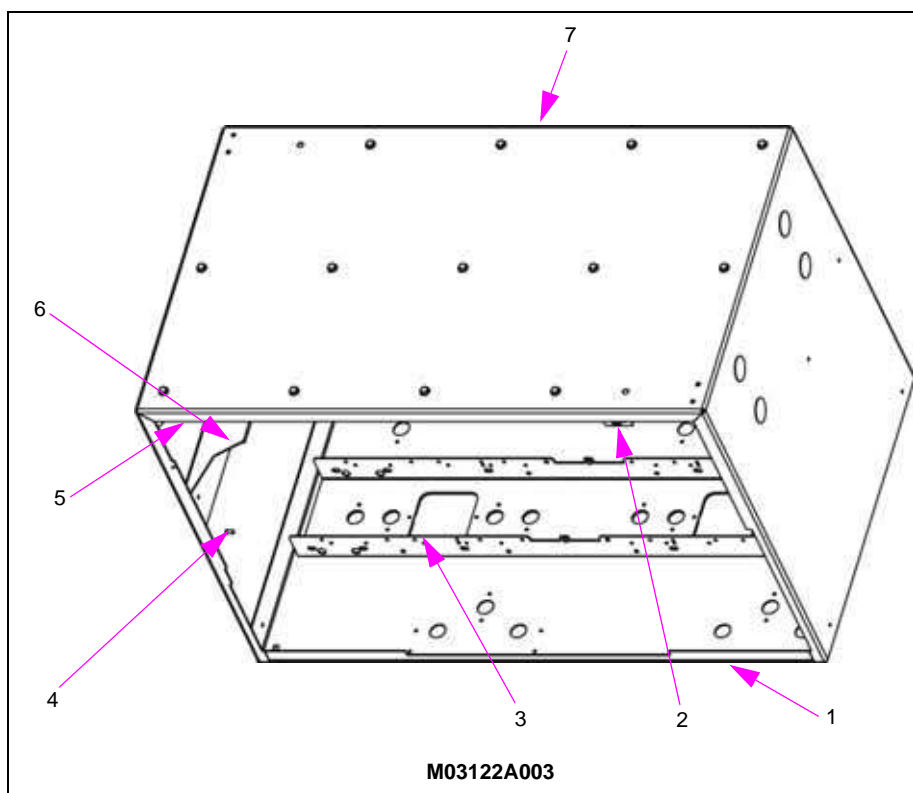

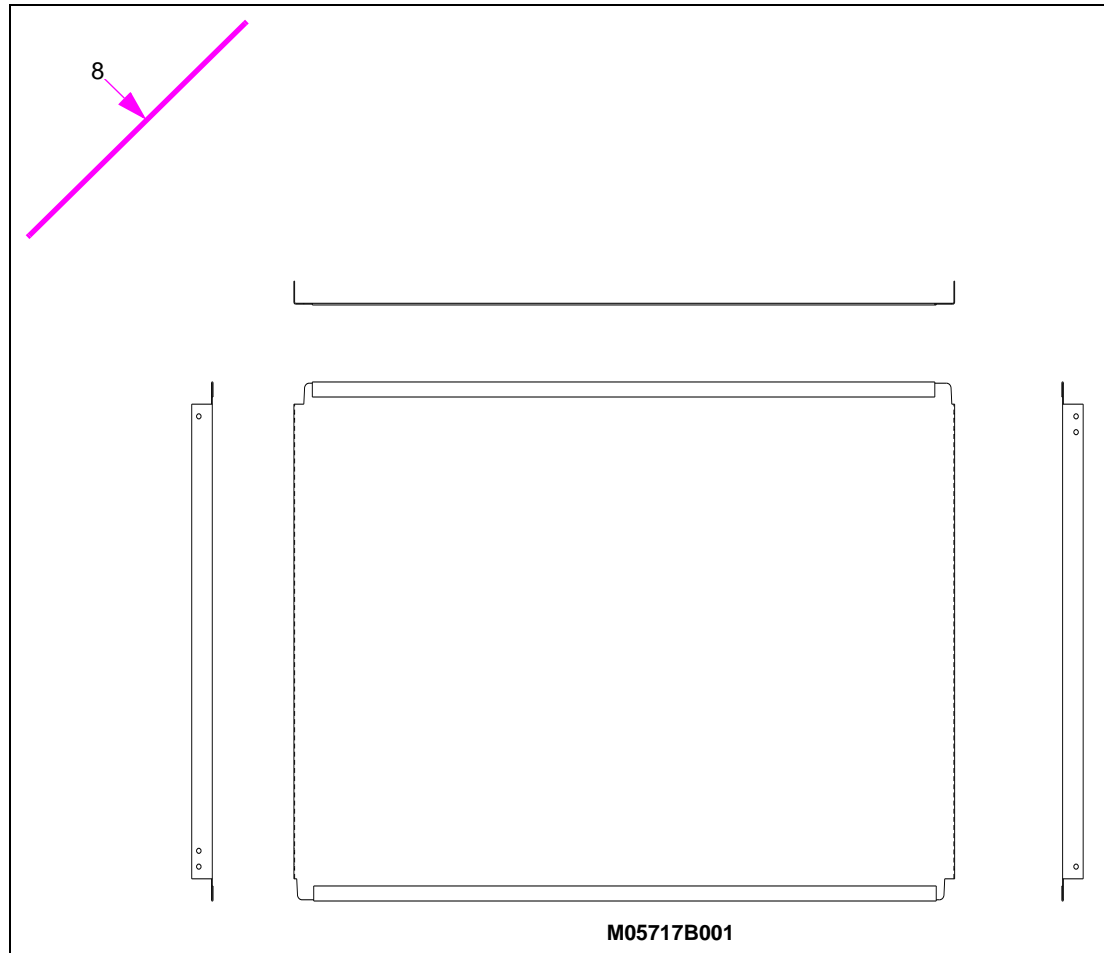

| Item # | Description | Current Part | Previous Part | Quantity |
|---------------------|---|--------------|---------------|----------|
| Assembly, CD Module | | M03122A003 | M03122A002 | 1 |
| 1 | Housing, CD Lower Frame | M03123B002 | - | 1 |
| 2 | Bracket, Prop Holding | M06017B001 | - | 2 |
| 3 | Rail, Center Lower C | M03488B001 | - | 1 |
| 4 | Stud, Weld, Metric M5 X 12 (see note 1) | Q12887-34 | M04445B002 | 4 |
| 5 | Bracket, CD Corner | M00308B001 | - | 4 |
| 6 | Rail, Center Upper T | M00307B002 | - | 2 |
| 7 | Housing, CD Upper Frame (see note 2) | M11993B001 | M00310B002 | 1 |
| 8 | CD Module Top Cover | M05717B001 | - | 1 |

Notes:

1. M04445B002 Stud is replaced by Q12887-34.

2. M00310B002 Housing, CD Upper Frame is replaced by M11993B001.

Sheathing - Encore 300/500

Note: Different sheathings are color coded. Before ordering sheathing, specify the required color.

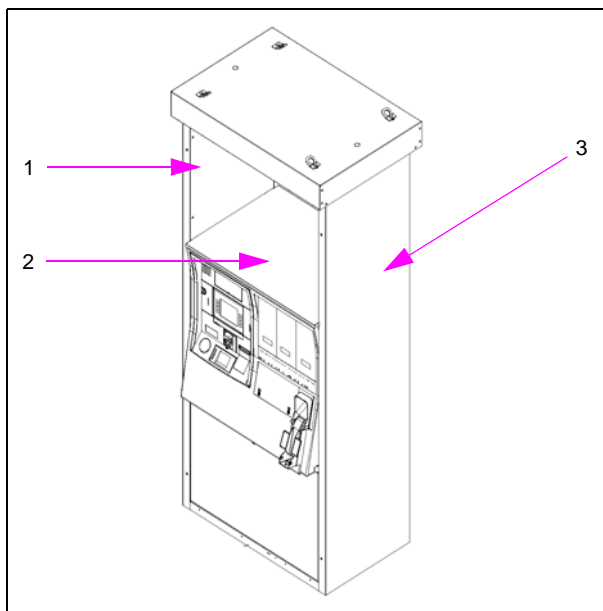

| Item # | Description | Current Part | Previous Part | Remarks |
|---|--|--------------|---------------|--|
| 1 | Sheathing, Inner Column (Painted Steel) | M00586B001 | - | Painted Galvanized Steel [Color Required (see note)] |
| | Sheathing, Inner Column (Unpainted Stainless Steel) | M00586B002 | - | (see note) |
| - | • Screw, M5 X 12 Machine Phillips Pan-head | | | Stainless Steel |
| 2 | Computer Display Module Top cover | M00467B001 | - | Painted [Color Required (see note)] |
| 3 | 1-piece Outer Column Sheathing (Painted Steel) | M00588B001 | - | • Painted • Painted Galvanized Steel [Color Required (see note)] |
| | 1-piece Outer Column Sheathing (Unpainted Stainless Steel) | M00588B002 | - | (see note) |
| - | • Screw, M5 X 12 Machine Phillips Pan-head | | - | Stainless Steel |
| <i>Note: All stainless steel parts are noted as such. Customer must specify paint code when ordering.</i> | | | | |

Sheathing - Encore 550

Note: Different sheathings are color coded. Before ordering sheathing, specify the required color.

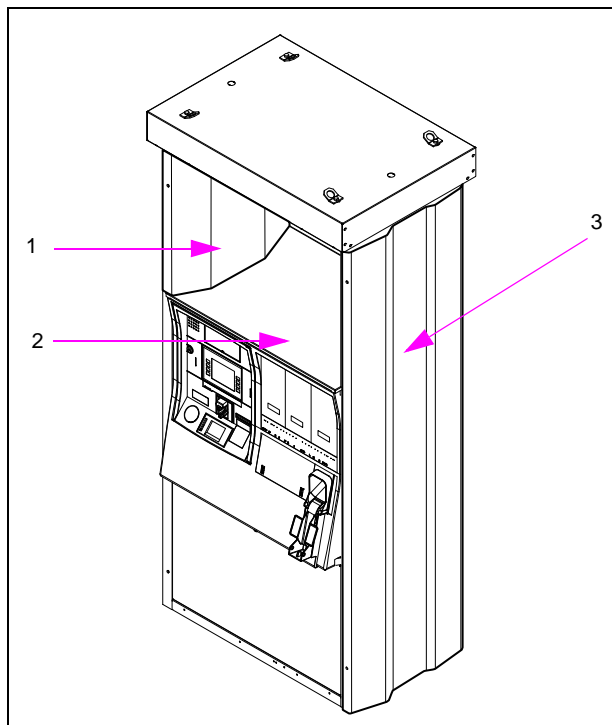

| Item # | Description | Current Part | Previous Part | Remarks |
|---|--|--------------|---------------|---|
| 1 | Sheathing, Inner Column (Painted Steel) | M05414B001 | - | Painted Galvanized Steel (Color Required) (see note) |
| | Sheathing, Inner Column (Unpainted Stainless Steel) | M05414B002 | - | (see note) |
| - | • Screw M5 X 12 Machine Phillips Pan-head | - | | Stainless Steel |
| 2 | Computer Display Module Top Cover | M03715B001 | - | Painted (Color Required) (see note) |
| 3 | 1-piece Outer Column Sheathing (Painted Steel) | M05415B001 | - | • Painted • Painted Galvanized Steel (Color Required) (see note) |
| | 1-piece Outer Column Sheathing (Unpainted Stainless Steel) | M05415B002 | - | (see note) |
| - | • Screw M5 X 12 Machine Phillips Pan-head | - | - | Stainless Steel |
| <i>Note: All stainless steel parts are noted as such. Customer must specify paint code when ordering.</i> | | | | |

Encore Column Sheathing Protectors

| Item # | Description | Current Part | Previous Part | Remarks |
|--------|---|--------------|---------------|---------|
| 1 | Shell® 3M™ 3690-10 (0.002" PS White Vinyl with no Polyester Overlaminate) | M05545B001 | - | - |
| 2 | Clear [Using 3650-114 (Clear Vinyl) and no Ink] | M05545B002 | - | - |
| 3 | Silver #2752 for ExxonMobil® | M05545B003 | - | - |

Upper Housing

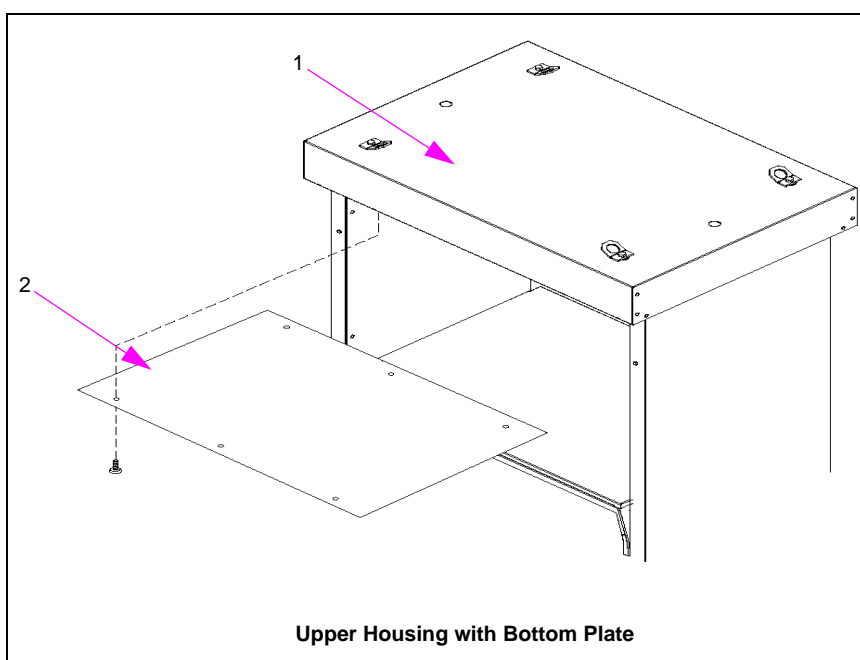

| Item # | Description | Current Part | Previous Part | Remarks |
|--|-----------------------------------|--------------|---------------|---|
| 1 | Upper Housing Top Cover (Painted) | M00578A001 | - | <ul style="list-style-type: none"> Painted Painted Galvanized Steel (Color Required) (see note) |
| 2 | Upper Housing Bottom Plate | M00589B001 | - | Painted [Color Required (see note)] |
| | • Screw, Metric M5 X 10 | - | - | - |
| | • Screw, Metric M5 X 12 | - | - | Stainless Steel Head Painted Black |
| 3 | Upper Housing - Tuxedo Sheathing | M05588XXXX | | Painted (Color Required) |
| Note: All stainless steel parts are noted as such. Customer must specify paint code when ordering. | | | | |

SMART Meter Mounting Bracket - Encore 550

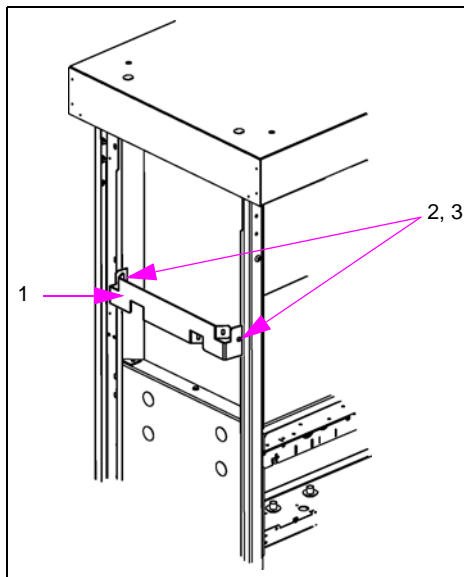

| Item # | Description | Current Part | Previous Part | Quantity |
|--------|------------------------|--------------|---------------|----------|
| 1 | Meter Mounting Bracket | M03645B003 | M03645B001 | 1 |
| 2 | • Screw, M8 X 16 | - | - | 2 |
| 3 | • Nut, Serrated M8 | M00414B003 | - | 2 |

Ecometer Mounting Bracket

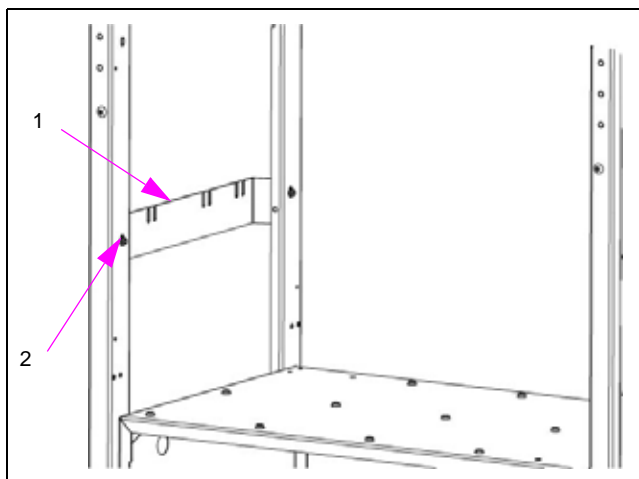

| Item # | Description | Current Part | Previous Part | Quantity |
|--------|---|--------------|---------------|----------|
| 1 | Mounting Bracket | M07567A001 | - | 1 |
| 2 | • Nut, Metric Hexagonal Serrated Flange | M00414B002 | - | 2 |

Panels - Encore 300/500

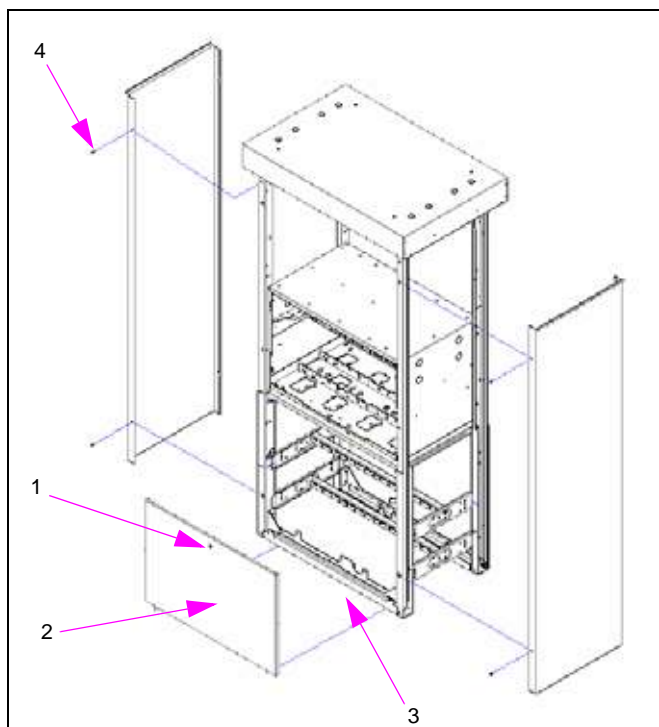

| Item # | Description | Current Part | Previous Part | Remarks |
|-------------------------------|---|--------------|---------------|---|
| 1 | Panel Lock Assembly with Key | K83512-30 | - | (see note 1) |
| 2 | Lower Panel (Painted Steel) | M00848B001 | - | Painted Painted Galvanized Steel |
| | Lower panel (Unpainted Stainless Steel) | M00848B002 | - | - |
| 3 | Base Rail Cover | M00585B001 | - | Painted [Color Required (see note 2)] |
| 4 | Screw, Thread Forming Phillips Pan-head, 12-24 (Head painted Silver) | M04287B001 | - | AR |
| Hardware, Sheathing/Top Cover | | M01105A001 | - | [Stainless Steel, Black (see notes 2 and 3)] |
| - | • Lifting Brackets (Top Cover) | - | - | - |
| - | • Bolt, Hexagonal-head, Metric (Top Cover) | - | - | - |
| - | • Washer, Rubber (Top Cover) | - | - | - |
| - | • Screw, Metric M5 X 10 Phillips Pan-head | - | - | Stainless Steel |
| - | • Screw, Metric M5 X 10 Phillips Pan-head | - | - | Black |
| - | • Screw, M5 X 10 Thread Forming Hexagonal-head | - | - | Black |
| - | • Screw, M5 X 10 Thread Forming Hexagonal-head | - | - | Stainless Steel |
| - | • Rivet, Pop 0.125 Diameter X 0.357 | - | - | - |

Notes:

1. Panel lock assembly with key parts are ordered as an assembly.
2. All stainless steel parts are noted as such. Must specify paint code when ordering.
3. Sheathing hardware parts are not illustrated. Customer to order parts as required. Parts can be ordered by entering part number M01105A001 or M01105A002.

Panels - Encore 550

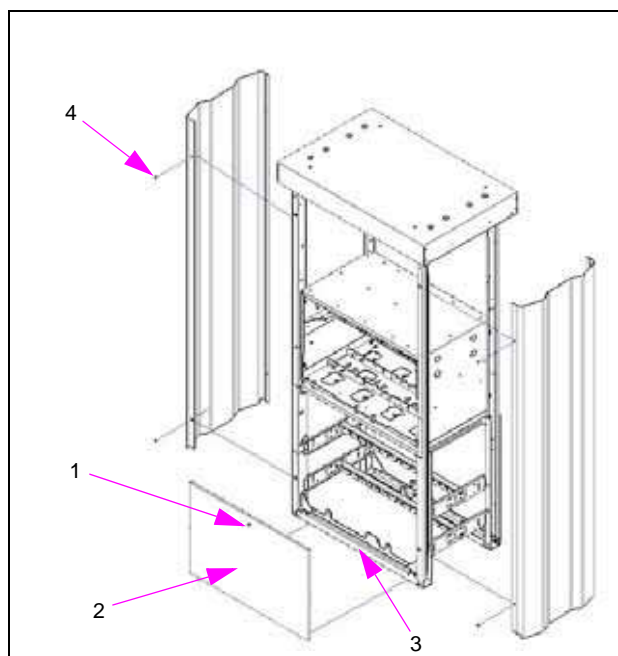

| Item # | Description | Current Part | Previous Part | Remarks |
|--------|---|--------------|---------------|---|
| 1 | Panel Lock Assembly with Key | K83512-30 | - | (see note 1) |
| 2 | Lower Panel (Painted Steel) | M00848B001 | - | Painted Painted Galvanized Steel |
| | Lower Panel (Unpainted Stainless Steel) | M00848B002 | - | - |
| 3 | Base Rail Cover | M00585B001 | - | Painted (Color Required) (see note 2) |
| 4 | Screw, Thread Forming Phillips Pan-head, 12-24 (Head painted Silver) | M04287B001 | - | AR |
| - | Hardware, Sheathing/Top Cover | M01105A001 | - | (Stainless Steel, Black) (see notes 2 and 3) |
| - | • Lifting Brackets (Top Cover) | - | - | - |
| - | • Bolt, Hexagonal-head, Metric (Top Cover) | - | - | - |
| - | • Washer, Rubber (Top Cover) | - | - | - |
| - | • Screw, Metric M5 X 10 Phillips Pan-head | - | - | Stainless Steel |
| - | • Screw, Metric M5 X 10 Phillips Pan-head | - | - | Black |
| - | • Screw, M5 X 10 Thread Forming Hexagonal-head | - | - | Black |
| - | • Screw, M5 X 10 Thread Forming Hexagonal-head | - | - | Stainless Steel |
| - | • Rivet, Pop 0.125 Dia X 0.357 | - | - | - |

Notes:

1. Panel lock assembly with key parts are ordered as an assembly.
2. All stainless steel parts are noted as such. Must specify paint code when ordering.
3. Sheathing hardware parts are not illustrated. Customer to order parts as required. Parts can be ordered by entering part number M01105A001 or M01105A002.

Panel Lock Assembly with Key

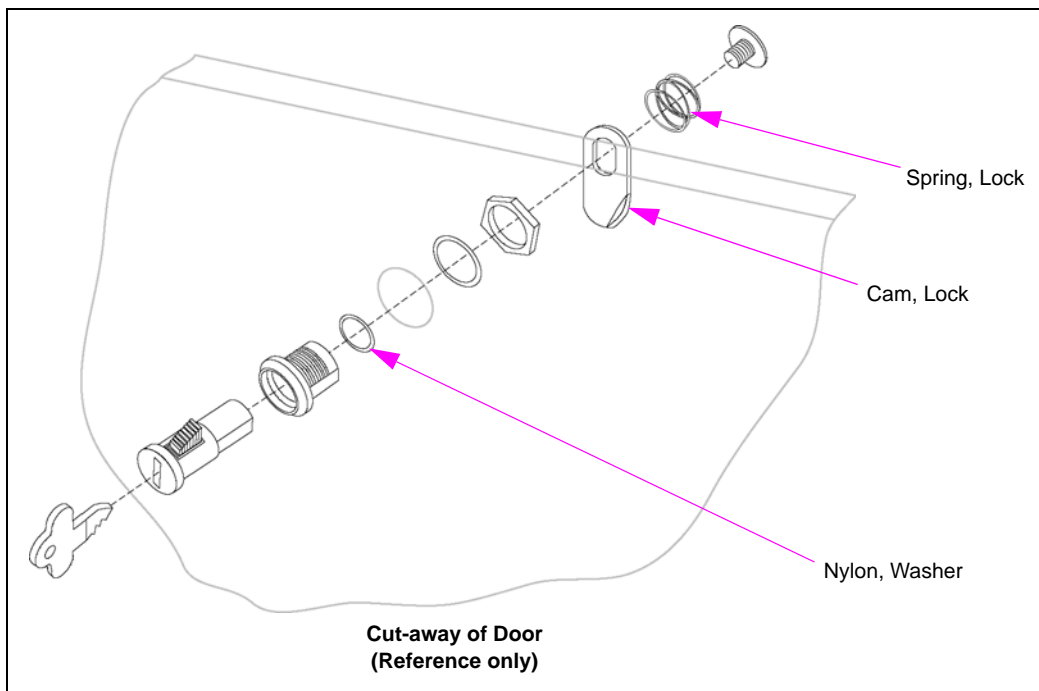

| Item # | Description | Current Part | Previous Part | Quantity |
|--------|------------------------------|--------------|---------------|------------|
| 1 | Panel Lock Assembly with Key | K83512-30 | - | (see note) |
| - | • Nylon, Washer | - | - | (see note) |
| - | • Spring, Lock | - | - | (see note) |
| - | • Cam, Lock | - | - | (see note) |

Note: Panel lock assembly with key parts are ordered as an assembly. Nylon-washer, spring-lock, and cam-lock can be ordered as order-entry items only.

Description of Part Number

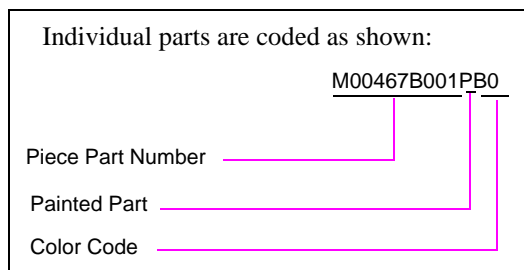

Sample of Color Codes

Note: Following table lists a few samples of the color code specifications. Color codes are codes used with a part number shown after the finished painted part. End codes are subject to change. Before ordering painted parts, specify the proper color code. For further help, contact a Gilbarco representative at 1-800-800-7498 for proper color code specification.

| Color Code | Color | End Code |
|------------|-------|----------|
| A0 | White | 2485 |
| B0 | Black | 2332 |
| C0 | Gray | 2556 |
| E0 | Gray | 2584 |
| F0 | Cream | 2583 |
| and so on | - | - |

Weldment CD Housing (Encore S Series)

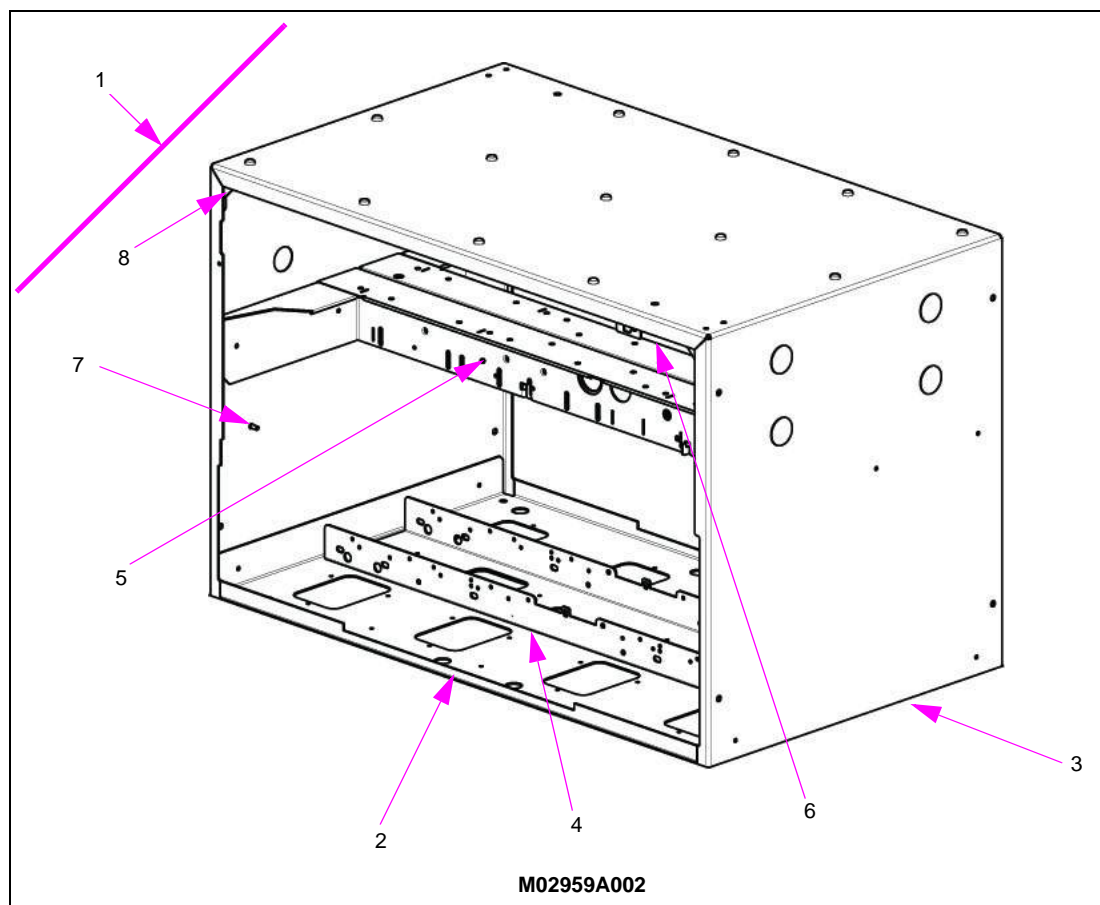

| Item # | Description | Current Part | Previous Part | Quantity |
|--|--|--------------|---------------|--------------|
| 1 | Weldment CD Housing | M02959A002 | M02959A001 | 1 |
| 2 | Housing, CD Lower Frame | M02938B002 | - | 1 |
| 3 | Housing, CD Upper Frame | M00310B002 | - | 1 |
| 4 | Rail, Center Lower C | M03488B002 | M03488B001 | 1 |
| 5 | Rail, Center Upper T | M00307B002 | - | 2 |
| 6 | Bracket, Prop Holding | M06017B001 | - | 2 |
| 7 | Stud, Weld, Metric M5 X 12 (alternate part number, see note 1) | Q12887-34 | - | 4 |
| 8 | Bracket, CD Corner | M00308B001 | - | 4 |
| Not Shown | | | | |
| - | Tape, Adhesive | M02677B001 | - | (see note 2) |
| - | RTV Sealant | END-1576 | - | (see note 2) |
| Notes: 1. (M04445B002) is an alternate part number for Item 7, Stud, Weld. 2. Quantity as required. | | | | |

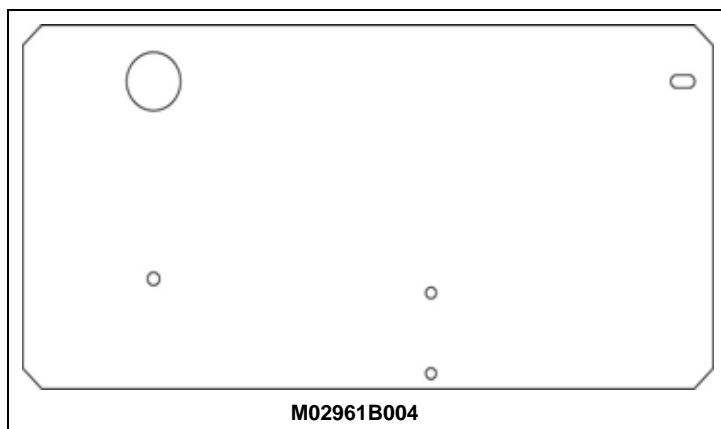
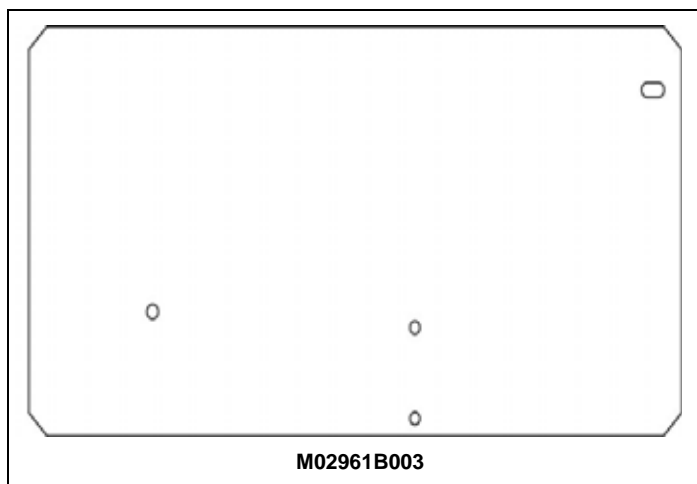

| Item # | Description | Current Part | Previous Part | Quantity |
|--------|--|--------------|---------------|----------|
| 1 | Blanking Plate - Encore 500 S | M02961B003 | - | 1 |
| 2 | Blanking Plate - Encore 500 S Ultra-Hi | M02961B004 | - | - |

Hose Retriever

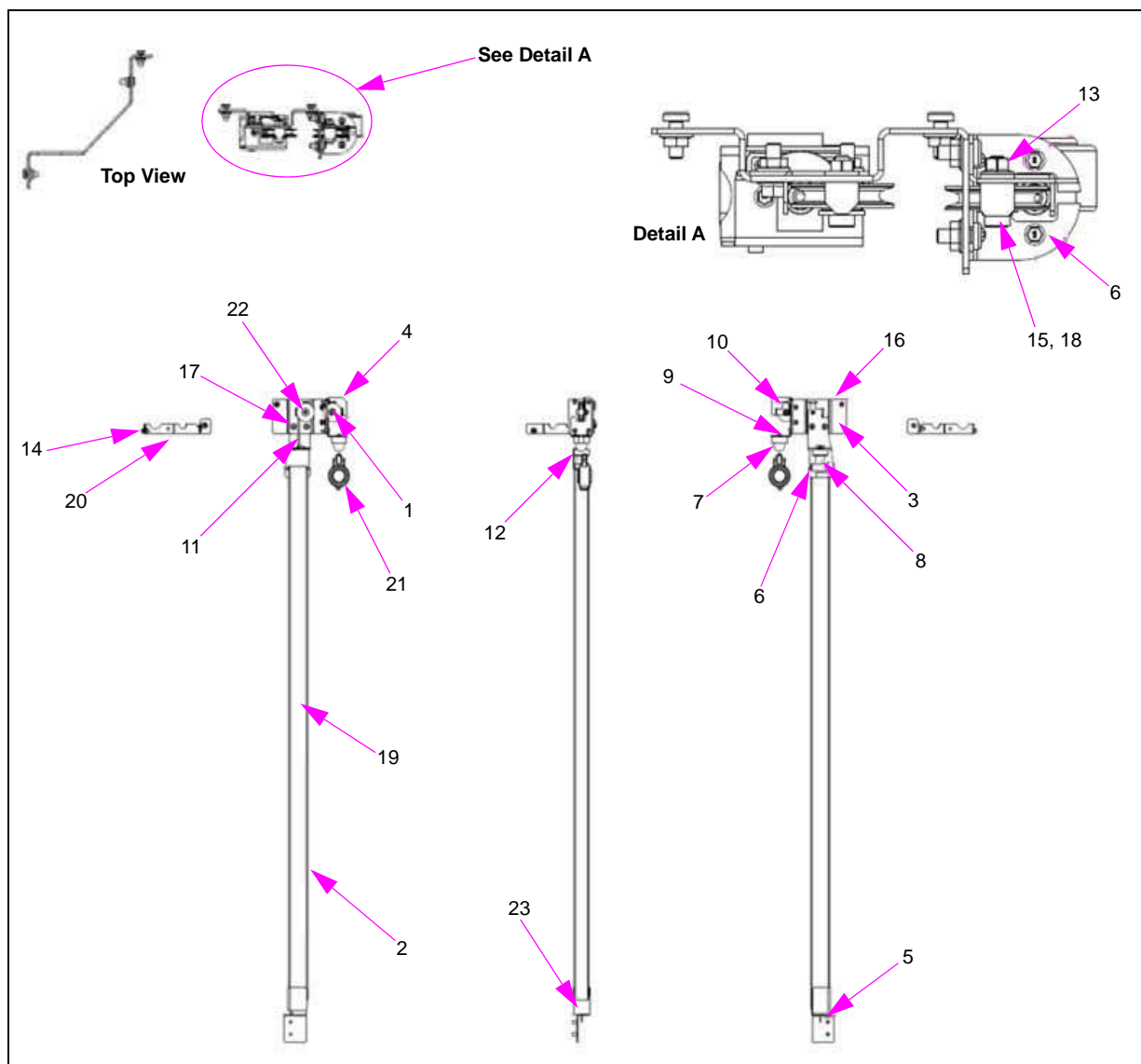

| Item # | Description | Current Part | Previous Part | Quantity |
|--------|--|--------------|---------------|----------|
| 1 | Assembly, Hose Retriever Pulley | M06434A001 | K85151 | 2 |
| 2 | Assembly, Retriever Weight | M12724A001 | M01925A001 | 1 |
| 3 | Bracket, Retriever Guide Inner, Encore | M04490B001 | - | 1 |
| 4 | Bracket, Retriever Guide, Outer, Encore | M01805B001 | - | 1 |
| 5 | Assembly, Bracket, Lower, Extended Reach | M14405A001 | M01809B002 | 1 |
| 6 | Bracket, Upper, Extended Reach | M12722B001 | M01916B001 | 1 |
| 7 | Bumper Stop, Rubber, Retrieval | M01918B001 | - | 1 |
| 8 | Bumper, Rubber | M11728B001 | M01993B001 | 1 |
| 9 | Cable Grommet | M12719B030 | R18450 | 2 |
| 10 | Cable Guide | N23485 | - | 1 |

| Item # | Description | Current Part | Previous Part | Quantity |
|--------|---|--------------|---------------|----------|
| 11 | Cord, Retriever Extended Reach, Encore 0.187 in Dia X 74" | M13161B001 | N23533-04 | 1 |
| 12 | Neoprene Pad | N23543 | - | 1 |
| 13 | Nut, Hexagonal Flanged Serrated Locking Face, 5/16-18 | Q11890-05 | - | 2 |
| 14 | Nut, Metric, Hexagonal Serrated Flange M8 | M00414B003 | - | 12 |
| 15 | Bolt, Socket Head Shoulder, 0.375 X 0.750, 5/16-18 | Q10113-102 | Q10113-02 | 2 |
| 16 | Screw, Metric, Socket Button Head M8 X 20 | M01257B010 | - | 10 |
| 17 | Screw, Metric, Hexagonal-head Serrated Flange M8 X 20 | M00415B010 | - | 2 |
| 18 | Washer, Narrow Gauge 0.312 X 0.065 | K66872-01 | - | 1 |
| 19 | Tube, Guide Weight | M12723B001 | M01923B001 | 1 |
| 20 | Bracket Support (Retriever) Encore XR (Balance) | M02586B001 | - | 1 |
| 21 | Clamp Hose | R19493-08 | - | 1 |
| 22 | Washer | K02206 | - | 1 |
| 23 | Pad, Shock Absorber | M12728B001 | - | 1 |

Hose Retriever (Encore 300)

| Item # | Description | Current Part | Previous Part | Quantity |
|--------|---------------------------|--------------|---------------|----------|
| - | Retriever Cable | K87218-02 | - | 8 |
| - | Hose Clamp Half | N18319-03 | - | 8 |
| - | Retriever, Reel and Cable | N20545-03 | - | 4 |

Frame and Sheathing for DEF Dispensers

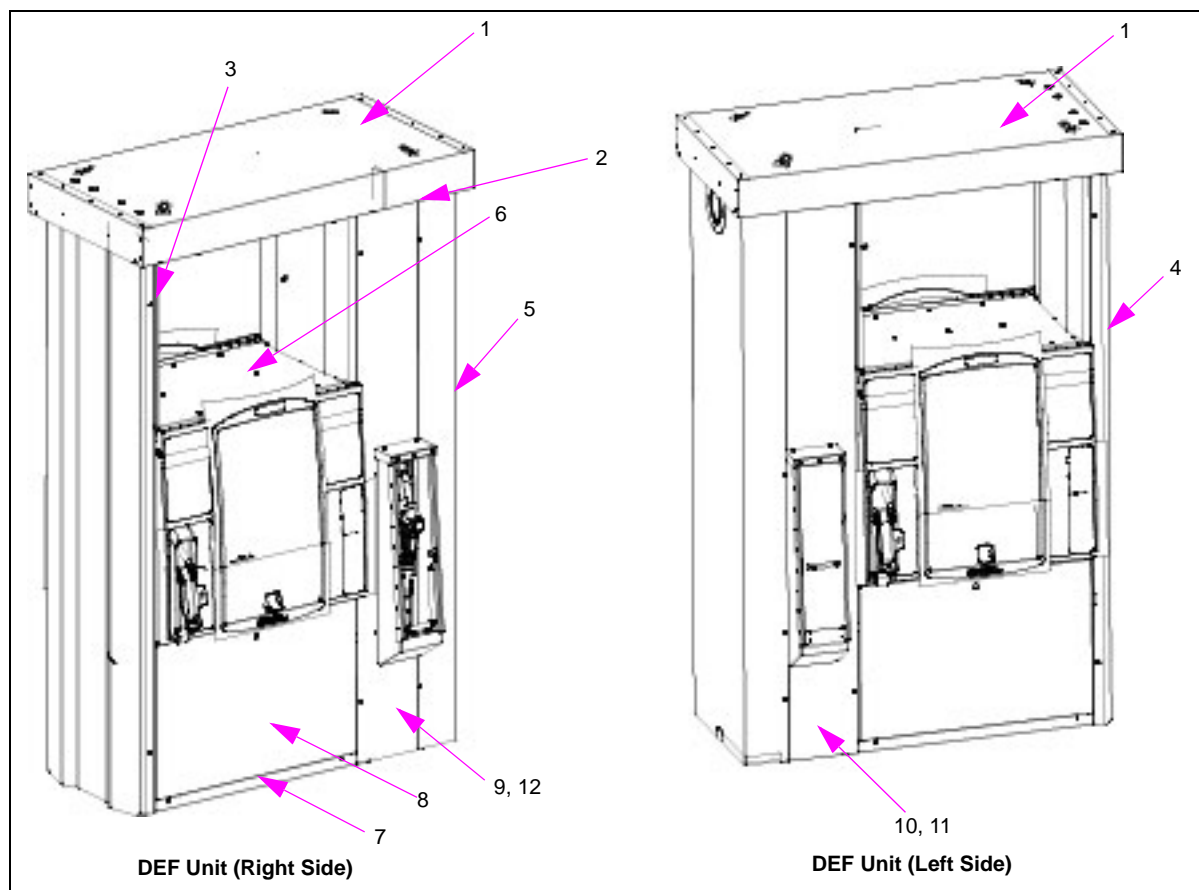

| Item # | Description | Current Part | Previous Part | Quantity |
|--------|--|--------------|---------------|----------|
| 1 | Upper Housing Top Cover (Hydraulics) | M11986A001 | - | 1 |
| 2 | Upper Housing Bottom Plate (Hydraulics) | M00589B002 | - | 1 |
| 3 | Sheathing, Inner Column | M05414B002 | - | 1 |
| 4 | Tuxedo Sheathing, Outer Column | M05415B002 | - | 1 |
| 5 | Flat Sheathing, Outer Column | M11980B001 | - | 1 |
| 6 | CD Module Top Cover | M05717B001 | - | 1 |
| 7 | Base Rail Cover | M00585B001 | - | 1 |
| 8 | Sheathing Lower Panel | M00848B002 | - | 1 |
| 9 | Assembly, Front Panel, DEF Module Right | M12378B001 | - | 1 |
| 10 | Assembly, Front Panel, DEF Module Left | M12379B001 | - | 1 |
| 11 | Assembly, Front Panel, Urea Module Left | M10763A001 | - | 1 |
| 12 | Assembly, Front Panel, Urea Module Right | M10762A001 | - | 1 |

DEF Insulation

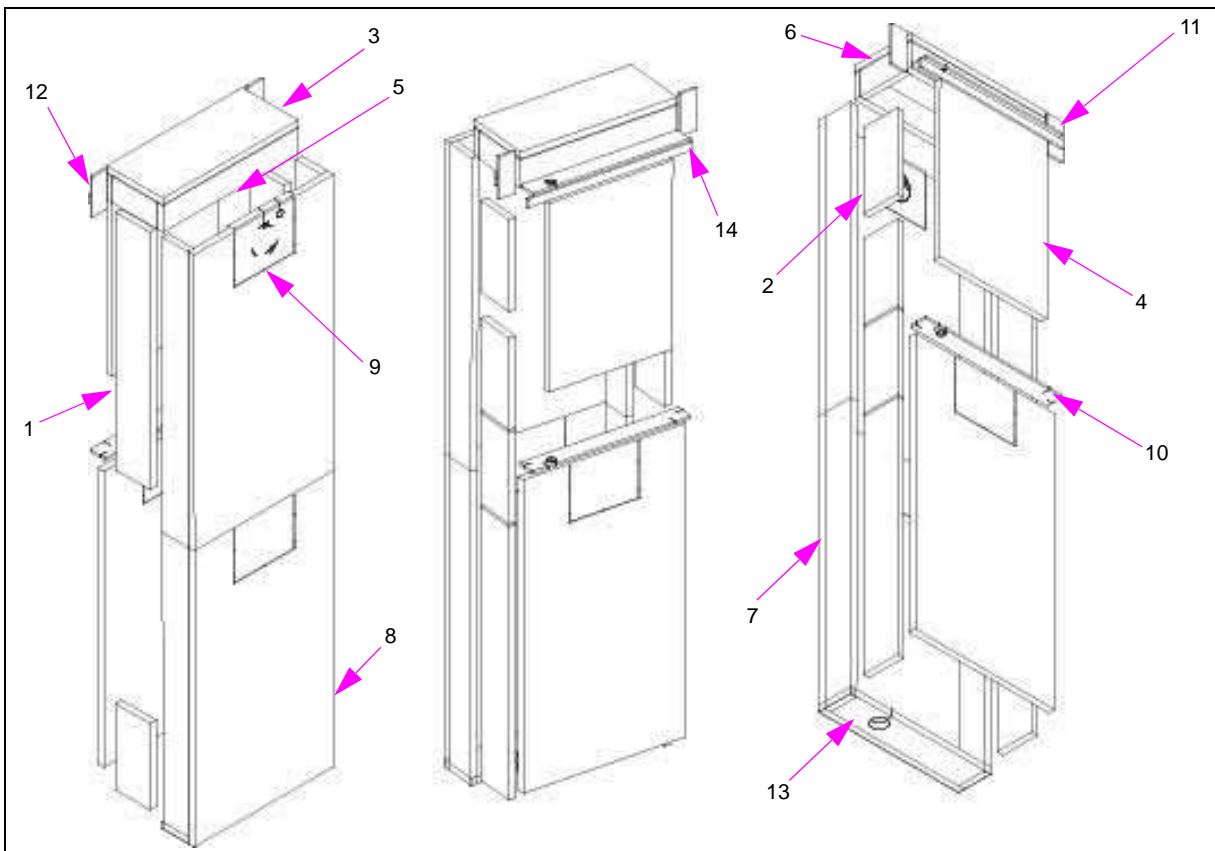

| Item # | Description | Current Part | Previous Part | Quantity |
|--------|---|--------------|---------------|----------|
| 1 | Assembly, Insulation Front/Rear Panel - Long | M10236A002 | - | 2 |
| 2 | Assembly, Insulation Front/Rear Panel - Short | M10263A003 | - | 4 |
| 3 | Assembly, Insulation Top | M10263A004 | - | 1 |
| 4 | Assembly, Insulation Inner Sheathing - Encore | M10263A005 | - | 1 |
| 5 | Assembly, Insulation Top Long Sides | M10263A006 | - | 2 |
| 6 | Assembly, Insulation Top Short Sides | M10263A007 | - | 2 |
| 7 | Assembly, Insulation Side Sheathing DEF | M10263A009 | - | 4 |
| 8 | Assembly, Insulation Long Side DEF | M10263A011 | - | 3 |
| 9 | Insulation, Inlet Top DEF Encore | M10263B012 | - | 1 |
| 10 | Insulation, DEF Encore | M10263B013 | - | 1 |
| 11 | Insulation, Top DEF Encore | M10263B014 | - | 1 |
| 12 | Insulation, DEF3 Encore | M10263B015 | - | 2 |
| 13 | Insulation, DEF3 Encore | M10263B016 | - | 1 |
| 14 | Insulation, DEF3 Encore | M10263B017 | - | 1 |

Bracket Pulley Assembly

Note: No longer in production. For information on Kit M10008K004, refer to “[Diesel Exhaust Fluid \(DEF\) Door Assembly](#)” on page 2-65.

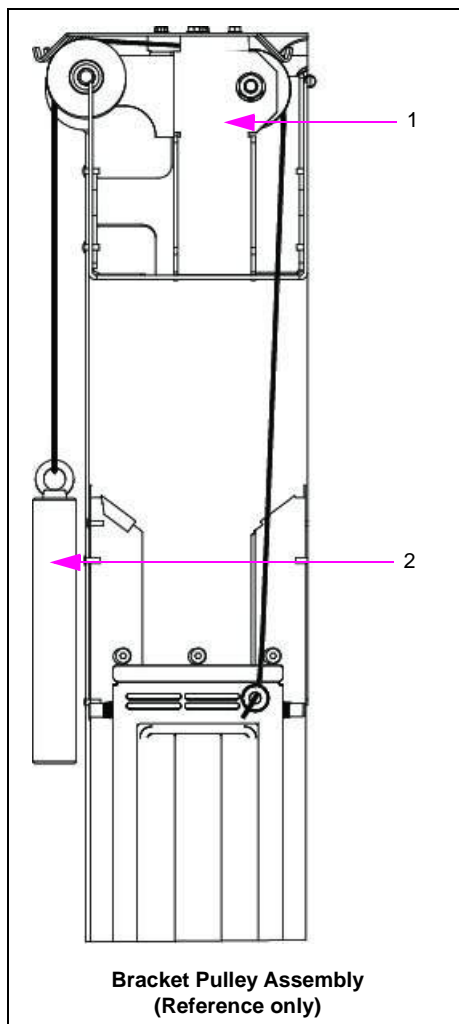

| Item # | Description | Current Part | Previous Part | Quantity |
|--------|----------------------------------|--------------|--------------------------|----------|
| 1 | Bracket Pulley Assembly - Double | - | M11228A001 M10223B001 | 1 |
| | Bracket Pulley Assembly - Single | - | M11227A001 M10222B001 | 1 |
| 2 | Balance Weight Nozzle Boot | - | M10224B001 | 1 |

Heater Support Assembly

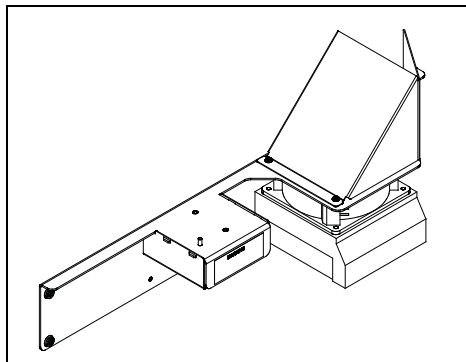

| Item # | Description | Current Part | Previous Part | Quantity |
|-----------------------------|---|--------------|---------------|----------|
| 1 | Heater Support Assembly (obsolete, see note) | - | M10417A001 | 1 |
| <i>Note: No replacement</i> | | | | |

Connector Access Cover

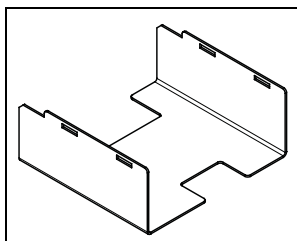

| Item # | Description | Current Part | Previous Part | Quantity |
|--------|------------------------|--------------|---------------|----------|
| 1 | Connector Access Cover | M10436B001 | - | 1 |

Brand-view Canopy Assembly

| Item # | Description | Current Part | Previous Part | Quantity |
|--------|----------------------------------|--------------|---------------|----------|
| 1 | Brand-view Canopy Assembly - DEF | EN55020GA### | - | 1 |