

## 7 – Commercial Electronics Section

### Commercial Front (Dual Depicted)

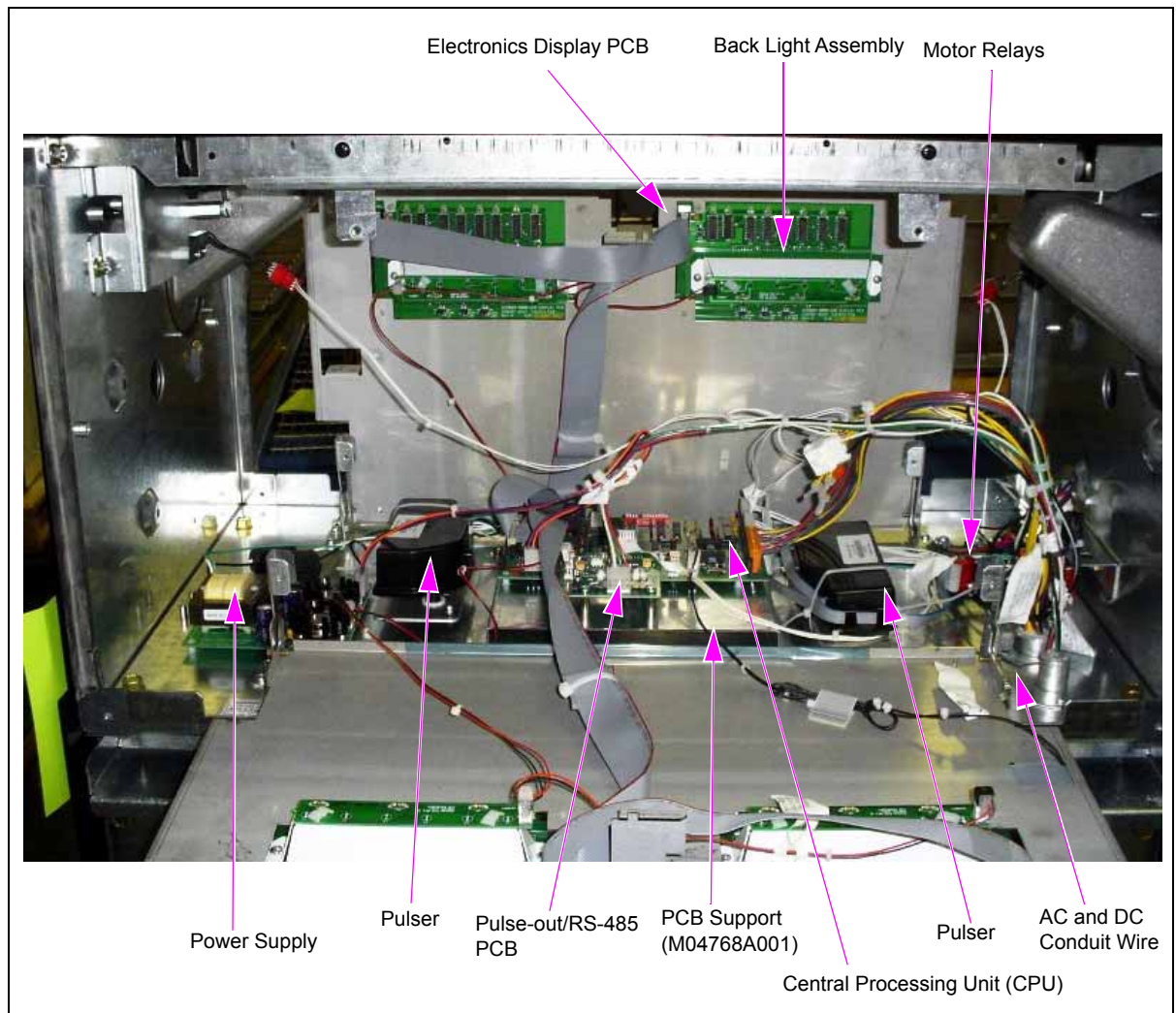

# Base Electronics

Refer to “Commercial PCBs (Non-Ultra-Hi)” on page 11-1.

# Power Supply

Refer to “Commercial PCBs (Non-Ultra-Hi)” on page 11-1.

# Pulser Assembly

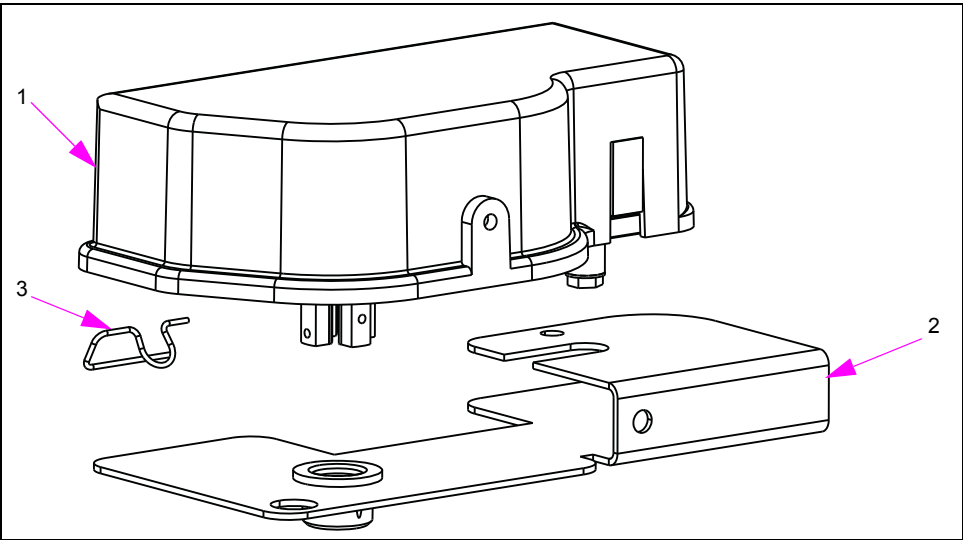

Item #	Description	Current Part	Previous Part	Quantity
1	Assembly, Pulser	M04011B001	T18350-G3	1
2	Assembly, Pulser Supt Bracket	M04485A001	-	1
3	Spring Retainer Pulser Shaft	M01207B001	-	1

# Motor Relays

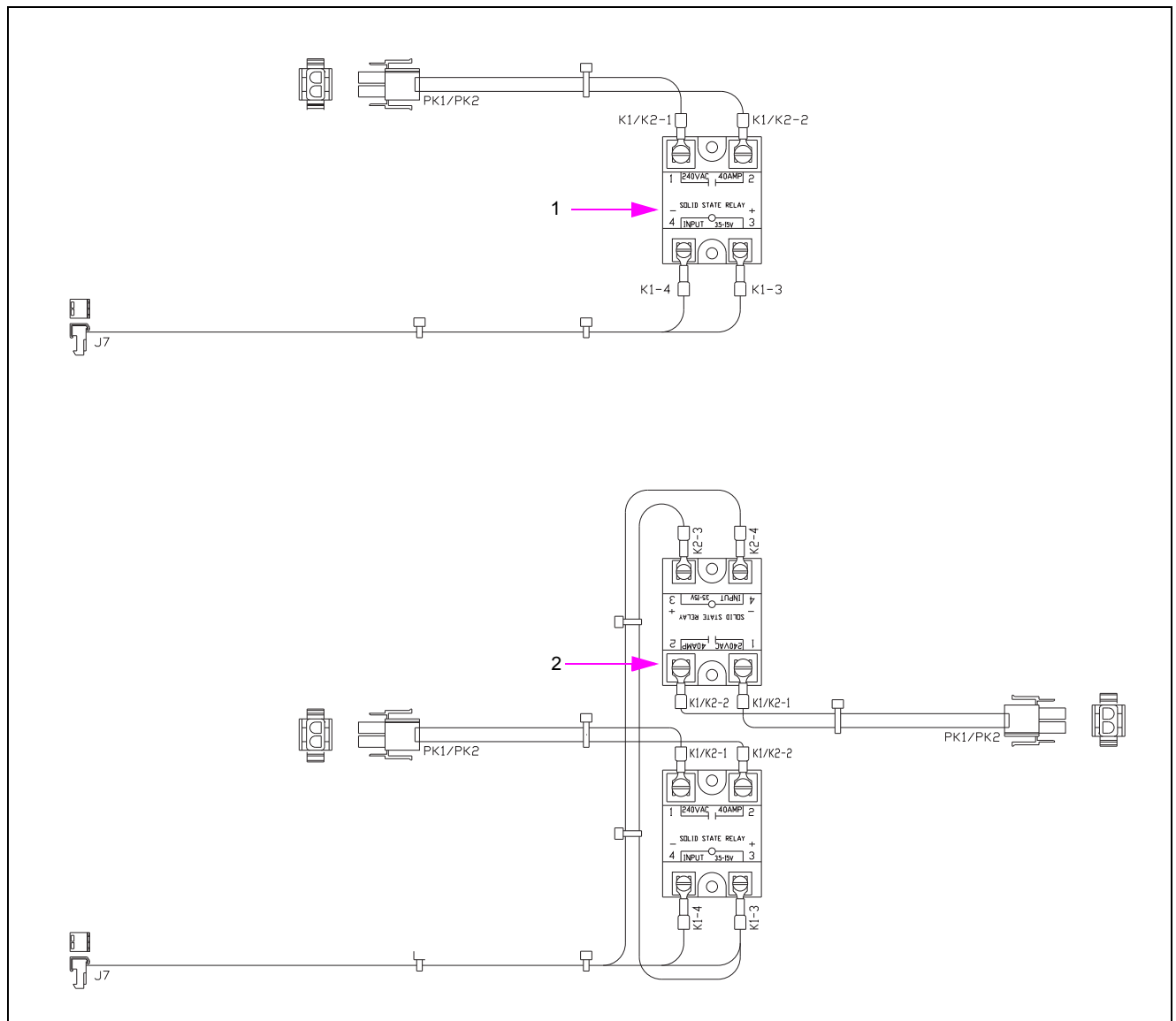

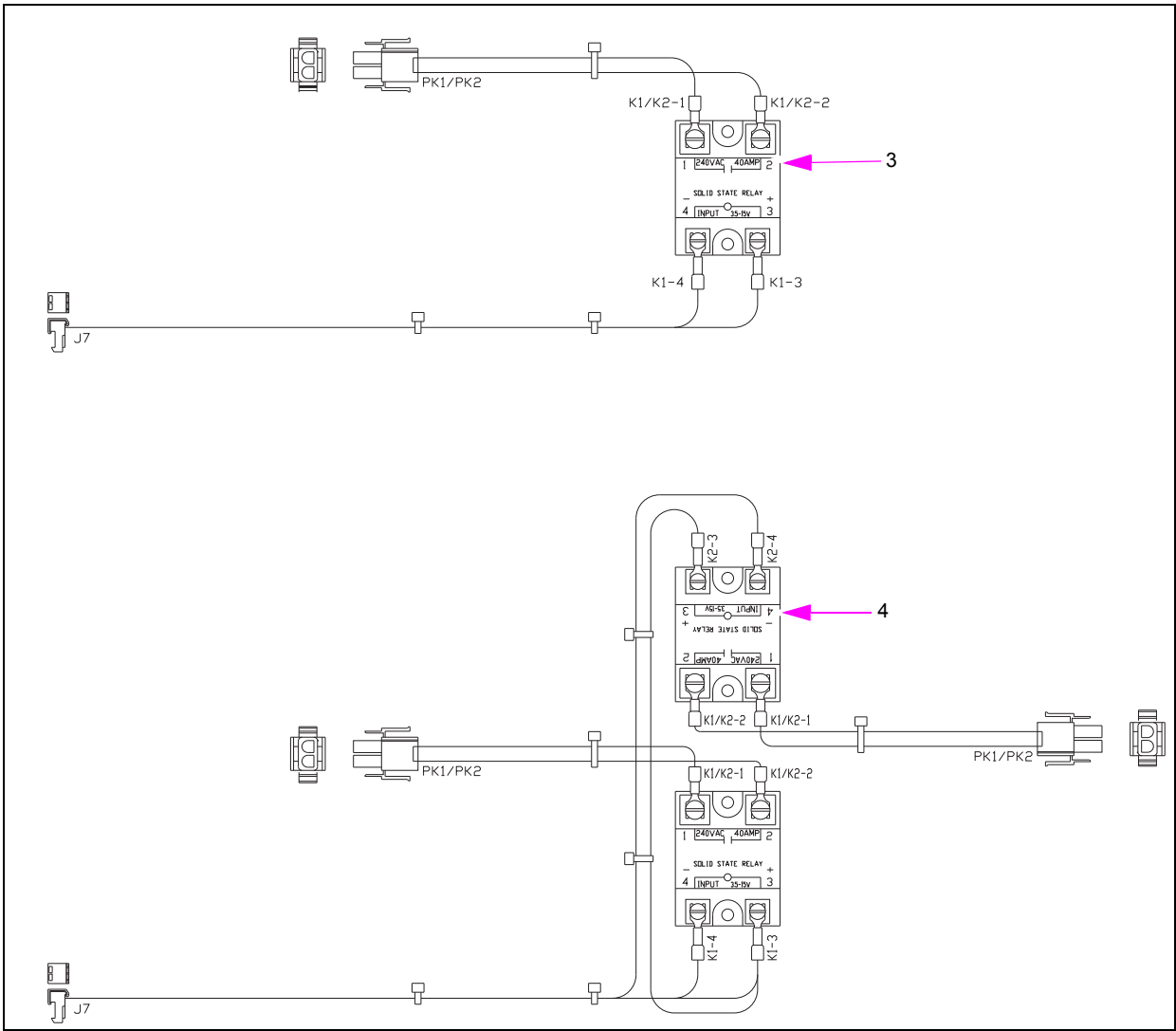

Item #	Description	Current Part	Previous Part	Quantity
1	Motor Relay, Comm Single	M04956A008	M04956A004	1
2	Motor Relay, Comm Dual	M04956A009	M04956A005	1
3	Motor Relay, E85 Single	M04956A010	-	1
4	Motor Relay, E85 Dual	M04956A011	-	1

## Main AC Conduit and Wire Assembly

Refer to “[Commercial Cables](#)” on [page 12-1](#).

## DC Conduit and Wire Assembly

Refer to “[Commercial Cables](#)” on [page 12-1](#).

## Electro-mechanical Totalizers

Refer to “[Commercial Cables](#)” on [page 12-1](#).