

2 – Sheathing, Doors, and Bezels

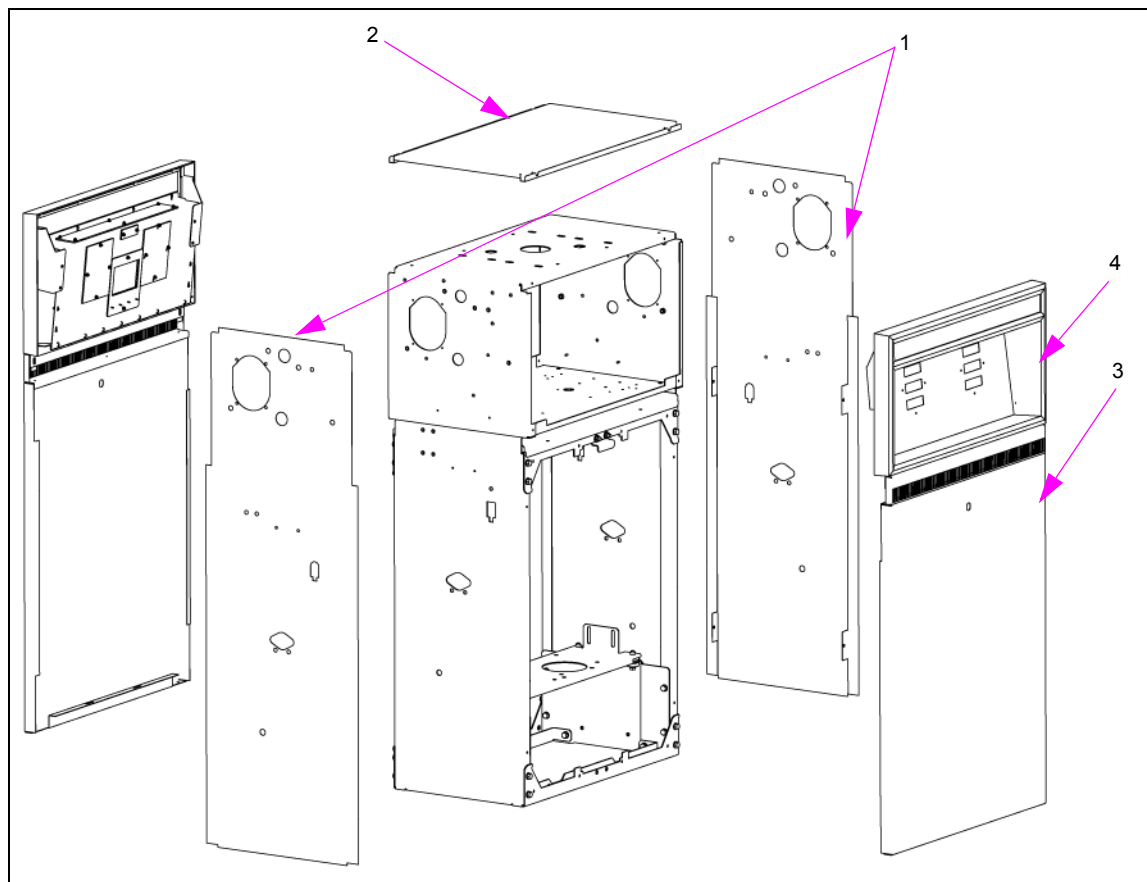

Item #	Description	Part Number
1	Side Panels	Refer to "Single-sided Units" on page 2-2 and/or "Dual-sided Units" on page 2-2 .
2	Top Panel	Refer to "Top Panels - Stainless Steel" on page 2-3 and/or "Top Panels - Painted" on page 2-3 .
3	Door	Refer to "Lower Doors" on page 2-4 .
4	Bezel	Refer to "Bezels" on page 2-5 .

Side Panel

Single-sided Units

All single-sided units feature one blank panel and unit-specific panel as noted in the following table.

Dual-sided Units

All dual-sided units feature two unit-specific panels as noted in the following table.

Note: To order painted panels, you must include both panel numbers and paint code. Refer to “Paint Codes” on page 1-3.

All panels are attached to the frame with four 12-24 X 1/2-inch long thread-forming pan head screws.

Stainless Steel	Painted	Panel Description
Models 9140, 9840, and 9850 Super-Hi™ and Ultra-Hi Flow		
M06485B001	M06485B101	Standard Blank Panel
M06485B002	M06485B102	Pump, Electronic Side-load
M06485B003	M06485B103	Pump, Front-load
M06485B004	M06485B104	Pump Auto-on with Keypad, Side-load
M06485B005	M06485B105	Pump, Auto-on, Side-load
M06485B006	M06485B106	Pump, Mechanical
M06485B007	M06485B107	Dispenser, Electronic Side-load
M06485B008	M06485B108	Dispenser, Front-load
M06485B009	M06485B109	Dispenser, Auto-on with Keypad, Side-load
M06485B010	M06485B110	Dispenser, Auto-on, Side-load
M06485B011	M06485B111	Dispenser, Mechanical
Models 8753KX, 8853KX, 9153KX, and 9853KX High Flow with Satellite Connections		
M06485B001	M06485B101	Standard Blank Panel
M06487B006	M06487B106	Dispenser, Electronic Side-load with Satellite Piping
M06487B007	M06487B107	Dispenser, Front-load with Satellite Piping
M06487B008	M06487B108	Dispenser, Auto-on with Keypad, Side-load, with Satellite Piping
M06487B009	M06487B109	Dispenser, Auto-on, Side-load, with Satellite Piping
M06487B010	M06487B110	Dispenser, Mechanical
Models 9140, 9840, and 9850 Super-Hi and Ultra-Hi Flow		
M06486B001	M06486B101	Super-Hi Blank Panel
M06486B002	M06486B102	Super-Hi Flow, Electronic Side-load, Pump or Dispenser
M06486B003	M06486B103	Super-Hi Flow, Front-load, Pump or Dispenser
M06486B004	M06486B104	Super-Hi Flow, Auto-on with Keypad, Side-load, Pump or Dispenser
M06486B005	M06486B105	Super-Hi Flow, Auto-on Side Load, Pump or Dispenser
M06486B006	M06486B106	Super-Hi Flow, Mechanical Pump or Dispenser
M06486B008	M06486B108	Ultra-Hi Flow, Side-load, Pump or Dispenser
M06486B009	M06486B109	Ultra-Hi Flow, Front-load, Pump or Dispenser

Side Panel Cosmetic Plugs

Note: Side panels have holes for all options offered on the specific model noted in the side panel table above. These kits contain plugs to cover un-used holes. Quantities are one per panel.

Kit Number	Description
M06506K001*	Panel Plug Kit, Standard-flow and High-flow Models
	Panel Plug Kit, Super-Hi Flow Models
	Panel Plug Kit, Ultra-Hi Flow Models
*Quantity is one per hose.	

Top Panels

Newer units use an industrial strength tape (K85492-78) to secure the top panel. Older top panels used four screws as shown in the first table below. Use the following tables to select the appropriate top panel for your unit:

Screws - All Top Panels

Part Description	Current Part	Previous Part	Quantity
Screw, Thread Forming Pan M6	N/A	M04287B001	4 per Panel

Top Panels - Stainless Steel

Unit Description	Part Description	Current Part	Previous Part	Quantity
Standard Electronic and Mechanical Units (Stainless Steel)	Top Sheath - Standard (Stainless Steel)	M04887B001	-	1 per Unit
Electronic Units with TopKAT™ Option (Stainless Steel)	Top Sheath - TopKAT (Stainless Steel)	M04887B002	-	1 per Unit
Mechanical One-sided Units with Electrical Keytrol Option (Stainless Steel)	Top Sheath - Electrical Keytrol, Single (Stainless Steel)	M04887B003	-	1 per Unit
Mechanical Dual-sided Units with Electrical Keytrol Option (Stainless Steel)	Top Sheath - Electrical Keytrol, Dual (Stainless Steel)	M04887B004	-	1 per Unit

Top Panels - Painted

Note: To order a painted panel, you must include the part number and paint code. Refer to “Paint Codes” on page 1-3.

Unit Description	Part Description	Current Part	Previous Part	Quantity
Standard Electronic and Mechanical Units (Painted)	Top Sheath - Standard (Painted)	M04887B011	-	1 per Unit
Electronic units with TopKAT option (Painted)	Top Sheath - TopKAT (Painted)	M04887B012	-	1 per Unit
Mechanical One-sided Units with Electrical Keytrol Option (Painted)	Top Sheath - Electrical Keytrol, Single (Painted)	M04887B013	-	1 per Unit
Mechanical Dual-sided Units with Electrical Keytrol Option (Painted)	Top Sheath - Electrical Keytrol, Dual (Painted)	M04887B014	-	1 per Unit

Lower Doors

Select appropriate door or door part for your unit from the following table:

Note: All units have two doors.

Unit Description	Door Description	Part Number	Quantity
Mechanical Model	Lower, Stainless Steel	GK01003GA001	2 per Unit
	Lower Panel, Painted or Decaled	GK01003GA__	2 per Unit
Electronic Model, Side-load	Lower Panel, Stainless Steel	GK01001GA001	2 per Unit
	Lower Panel, Painted or Decaled	GK01001GA__	2 per Unit
	Lower Panel with Front Totalizer, Stainless Steel	GK01006GA001	2 per Unit
	Lower Panel with Front Totalizer, Painted	GK01006GA__	2 per Unit
Electronic Model, Front-load Single-sided	Lower Panel with Boot Cutout, Stainless Steel	GK01002GA001	1 per Unit
	Lower Panel, No Cutout, Stainless Steel	GK01001GA001	1 per Unit
	Lower Panel with Boot Cutout, Painted or Decaled	GK01002GA__	1 per Unit
	Lower Panel, No Cutout, Painted or Decaled	GK01001GA__	1 per Unit
	Lower Panel with Front Totalizer and Boot Cutout, Stainless Steel	GK01007GA001	1 per Unit
	Lower Panel, No cutout, Stainless Steel	GK01001GA001	1 per Unit
	Lower Panel with Front Totalizer and Boot Cutout, Painted or Decaled	GK01007GA__	1 per Unit
	Lower Panel, No cutout, Painted	GK01001GA__	1 per Unit
Electronic Model, Front-load Dual-sided	Lower Panel, Stainless Steel	GK01002GA001	2 per Unit
	Lower Panel, Painted or Decaled	GK01002GA__	2 per Unit
	Lower Panel with Front Totalizer and Boot Cutout, Stainless Steel	GK01007GA001	2 per Unit
	Lower Panel with Front Totalizer and Boot Cutout, Painted or Decaled	GK01007GA__	2 per Unit
Notes: 1) All electronic models using the above doors must also have two Rain Guard Air Gap Baffle Plates (M06690B001). Refer to "Air Gap Hardware and Computer Display (CD) Module Housing" on page 9-1 . 2) Nozzle boot covers are included with front-load doors. 3) Ensure to include full part numbers when ordering painted or decaled doors.			

Additional Door Parts

Part Description	Part Number	Quantity
Panel Lock and Key Kit	K34673	1 per Door

Bezels

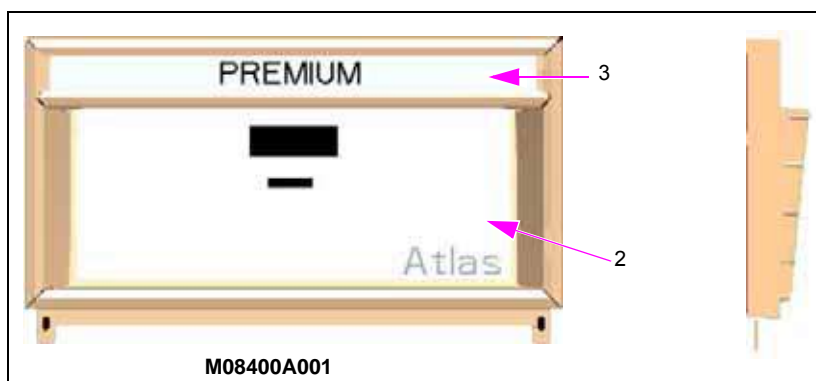

Bezel Parts

Item #	Part Description	Where Used	Current Part	Previous Part	Quantity
1	Bezel Assembly (see note 4)	All	M08400A001	-	1 per Bezel
2	Dial Face Graphic	All	(see note 1)	-	1 per Bezel
3	Brand Panel Graphic	All	(see note 2)	-	1 per Bezel

Notes:

1. To specify dial face graphic, the unit model number and unit of measure must be provided.
2. To specify the brand panel graphic, the description of the brand and color of print must be provided.
3. A Wiper Gasket (M08340B001) is used to seal the top inner edge of the bezel, to prevent water leaks. Detail B in the figure shows this gasket. It is attached by the two screws that attach the metal top cover.
4. Bezel Assembly (M08400A001) is sold as Atlas Bezel Kit.

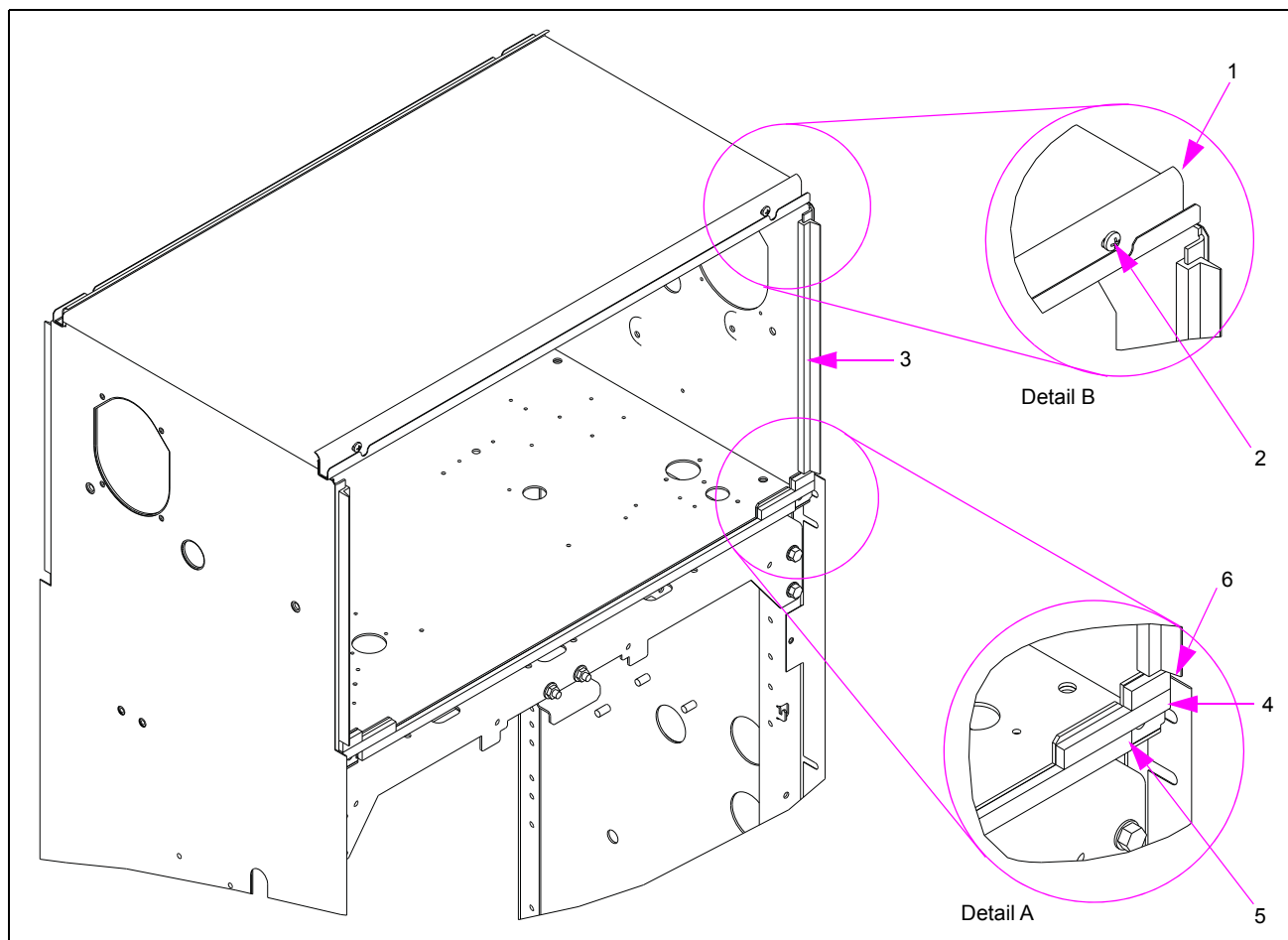

Item #	Part Description	Current Part	Previous Part	Quantity
<i>Following parts are sold as Atlas Bezel Sealing Gasket Kit (M08685K001):</i>				
1	Seal, Bezel Top	M08340B001	-	2
2	Screw, Thread FRM PH, 12-24 (Silver Painted Head)	M04287B001	-	4
3	Gasket, Upper Housing Side	M05095B001	-	4
4	Gasket 1/4 X 1/2 X 3.15	Q11899-08	-	4
5	Gasket 1/4 X 1/2 X 25.7	Q11899-08	-	2
6	Gasket 1/4 X 1/2 X 1	Q11899-08	-	4