

11 – Discharge Piping Section

Balance System Vapor Piping

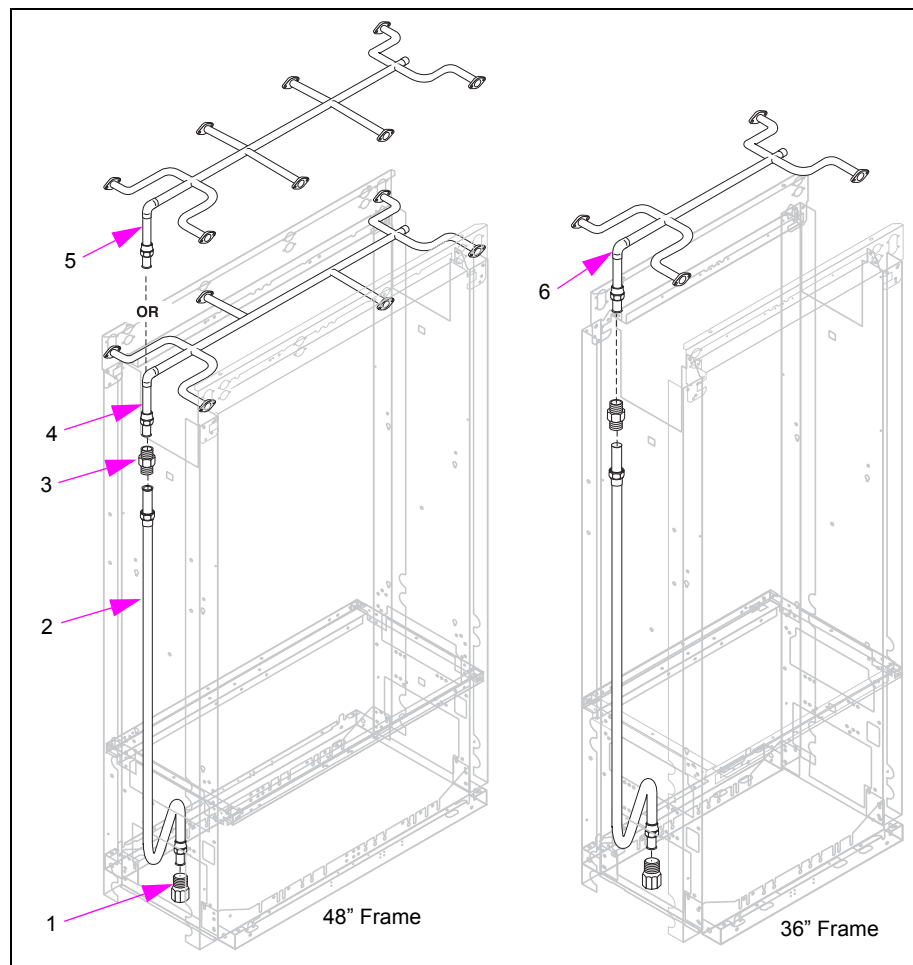

Item #	Part Description	Current Part	Previous Part	Quantity
1	Straight Fitting for Vapor Return Line	K93784-02	-	1
2	Lower Vapor Recovery Line			
	• Dispensers, Blenders	T18747-G1	-	1
	• Pumps (obsolete, see note 1)	-	T18241-G1	1
	• Vapor Recovery Retrofit Kits (K94275, K94276, and K94277)	W02888-G1	-	1
3	Coupling, 1"	K93489-02	-	1
4	Upper Vapor Recovery Line, 48"	W02987-G1	-	1

Item #	Part Description	Current Part	Previous Part	Quantity
5	Upper Vapor Recovery Line, 48", MPD 4-grade units only (see note 2)	W02987-G2	-	1
6	Upper Vapor Recovery Line, 36" (obsolete, see note 1) (see note 3)	-	W03015-G1	1
Not Shown				
-	Vapor Plug Plate (see note 4)	N23310	-	1
-	Vapor Plug Gasket (see note 4)	N23319	-	1
Notes: 1. No replacement. 2. W02987-G2 is not sold individually. It is sold as K94276 kit. 3. W03015-G1 is not sold individually. It is sold as K94277 kit. 4. Used to plug upper vapor recovery line outlets that do not receive a hose casting. 5. For VaporVac parts, refer to PT-1831 VaporVac Vacuum Assist Vapor Recovery Illustrated Parts Manual. 6. All parts may not be available as spare parts.				

Piping Brackets

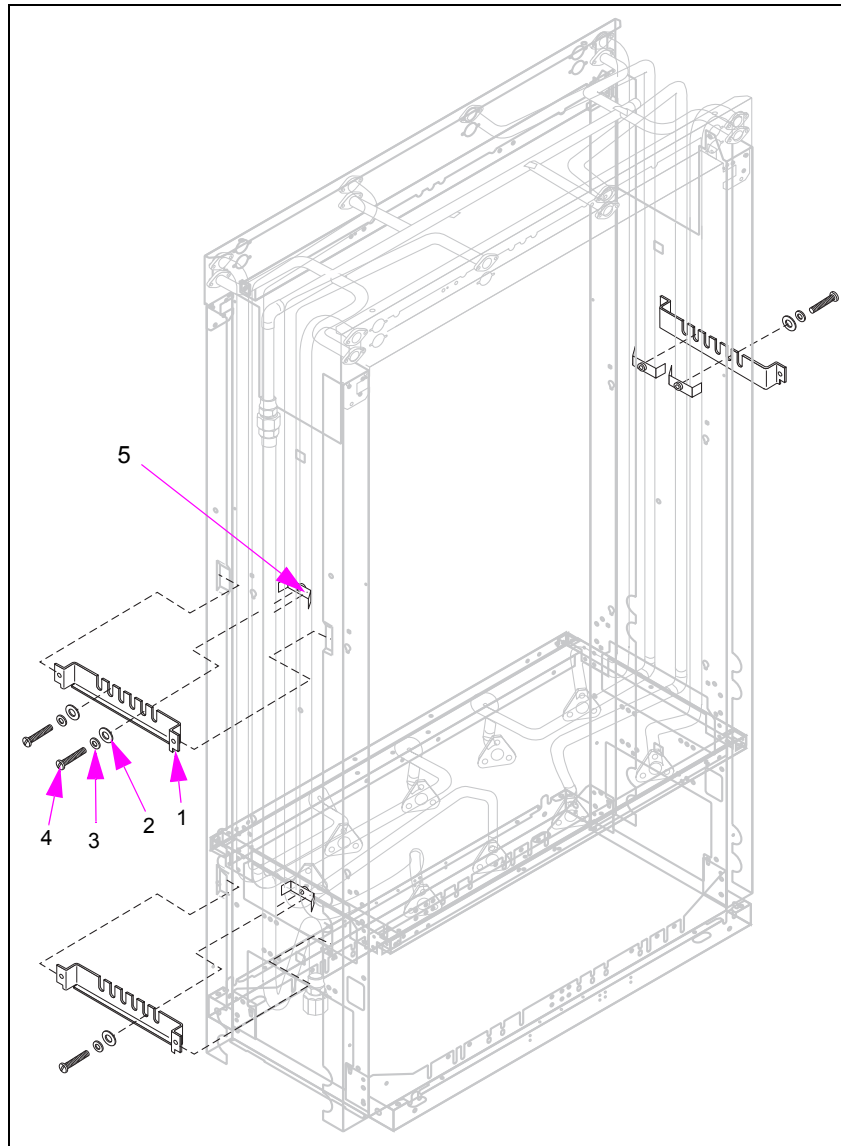

Item #	Part Description	Current Part	Previous Part	Quantity
1	Pipe Clamp Bracket	T18799-01	-	(see note 1)
2	Flat Washer, 1/4"	K14056	-	(see note 1)
3	Lock Washer, 1/4"	K50773	-	(see note 1)
4	Screw, 1/4-20 X 2"	K02447	-	(see note 1)
5	Pipe Clamp	N23644-G1	K95857 K92858	(see note 1)

Notes:
1. Quantity varies with model.
2. All parts may not be available as spare parts.

Hose Castings

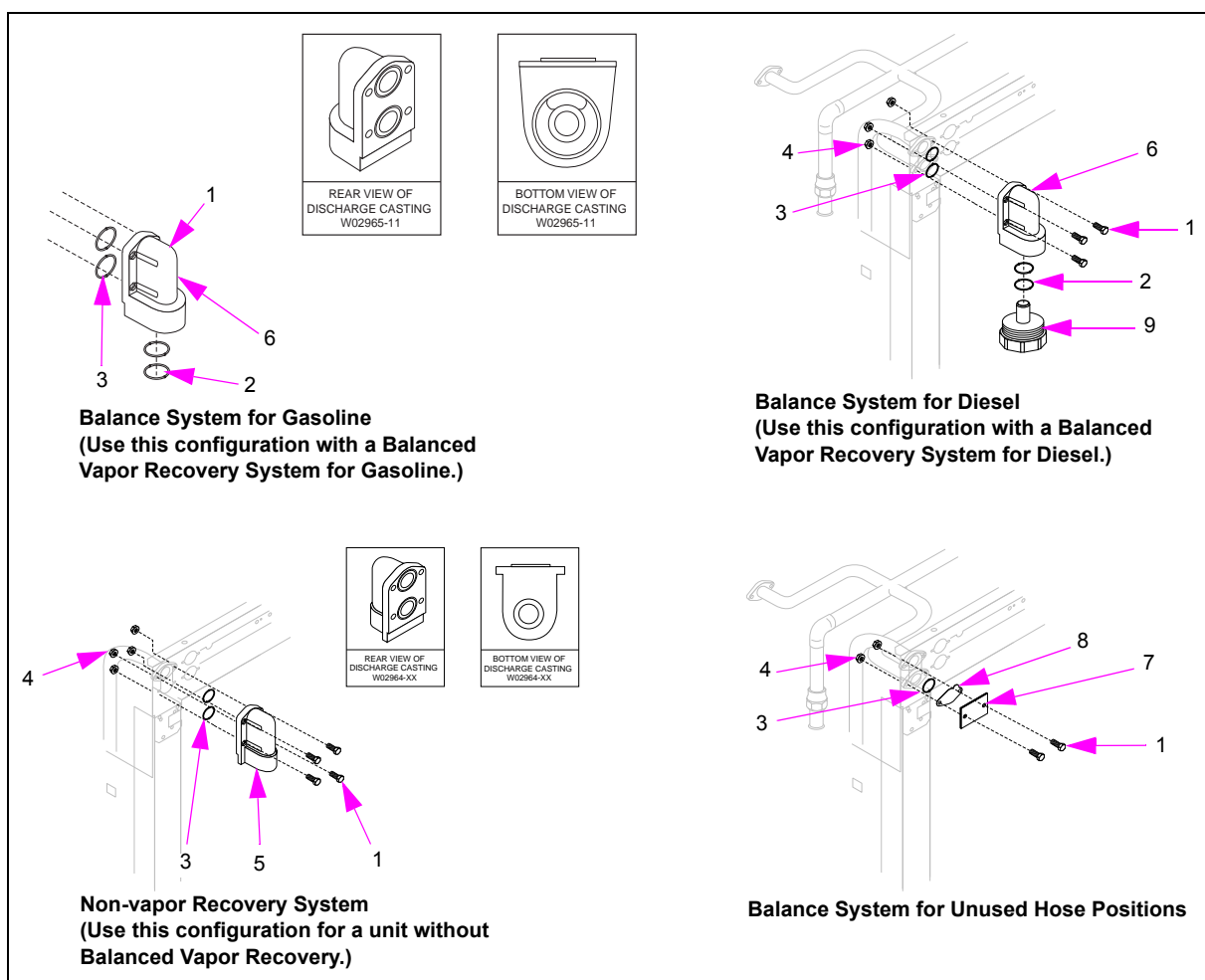

Item #	Part Description	Current Part	Previous Part	Quantity
1	Bolt, 5/16-18 X 1"	K07565	Q12619-01	4
2	O-ring, 11/16 X 13/16 X 1/16"	N16891-27	-	2
3	O-ring, 15/16 X 1-3/16 X 1/8"	N16891-25	-	2
4	Nut, 5/16"-18	Q11890-05	Q10977-05	4
5	Hose Outlet Casting (non-vapor recovery)			
	• Standard Flow (3/4" Outlet) (obsolete, see note 1)	-	W02964-10	1
	• High Flow (1" Outlet) (obsolete, see note 1)	-	W02964-11	1
	• Super-Hi Flow (1" Outlet)	W02964-14	-	1
6	Hose Outlet Casting (balanced vapor recovery)	W02965-11 W02964-04	W02965-04 W02964-02	1
7	Vapor Plug Plate (see note 2), For balance only	N23310	-	1
8	Vapor Plug Gasket (see note 2), For balance only	N23319	-	1
9	Hose Outlet Adapter Kit	K35471	-	(see note 3)
	• Hose Adapter	N22963-01	-	1
	• O-ring	N16891-30	-	1
Not Shown				
-	VaporVac Outlet	T18194-12	-	1
Notes: 1. No replacement. 2. Used on Single-hose and Blender units. Not used on Super-Hi™ units. 3. Quantity varies with model. 4. For VaporVac parts, refer to PT-1831 VaporVac Vacuum Assist Vapor Recovery Illustrated Parts Manual. 5. Previous parts are used on units built before 05/20/94. 6. All parts may not be available as spare parts.				

Visual Discharge Indicator

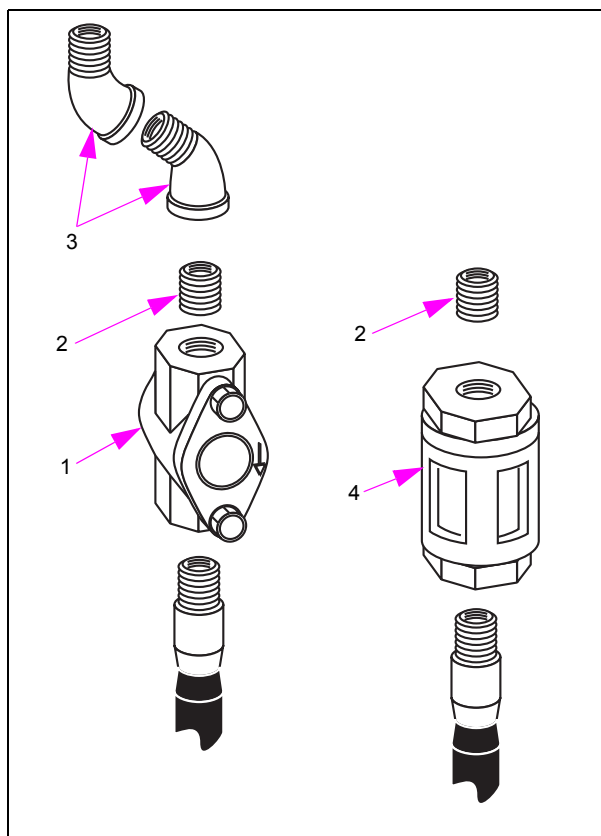

Item #	Part Description	Current Part	Previous Part	Quantity
1	Visual Discharge Indicator (see note 1) (obsolete, see note 2)	(see note 3)	N21549-01	(see note 4)
2	Nipple, 3/4 X 1-3/8"	R10907-46	K09760	(see note 4)
3	Elbow, 3/4" X 45° (see note 5)	-	K03608 K21479	(see note 4)
4	Visual Discharge Indicator	R20176-G1	-	(see note 4)

Notes:

1. Cannot be used on models with vapor recovery.
2. No replacement.
3. Purchase from OPW (<https://www.opwglobal.com/>), former OPW part number 1431.
4. Quantity varies with model.
5. K21479 is obsolete and no replacement.
6. All parts may not be available as spare parts.

One-grade, Two-hose Units

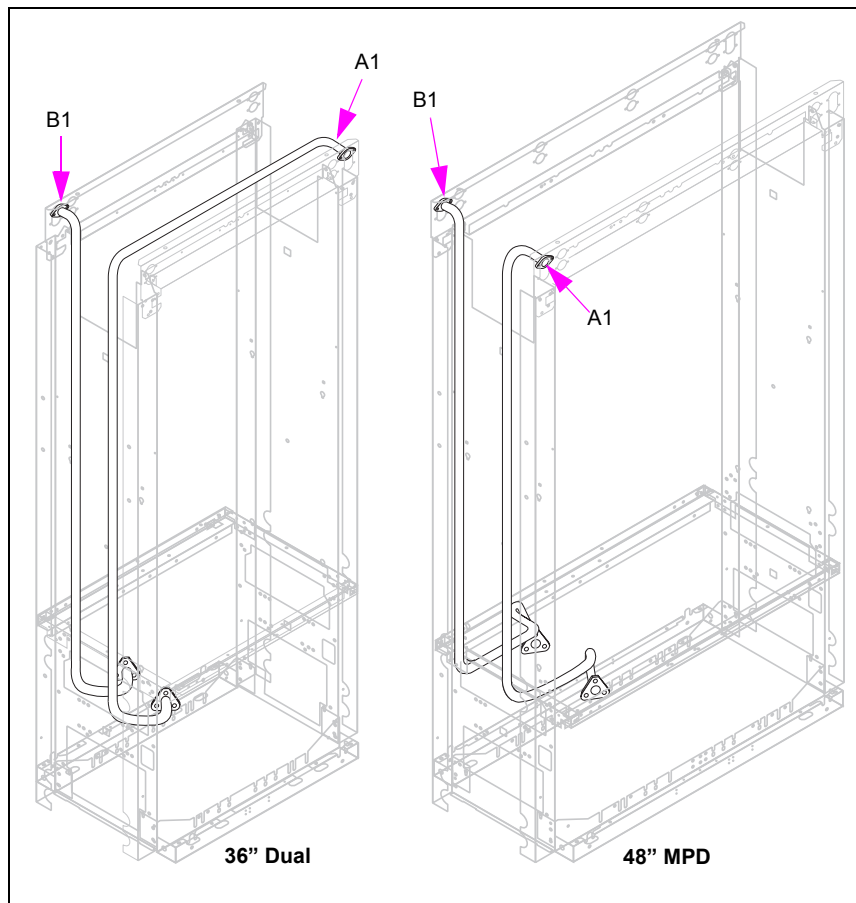

Unit	Discharge Line	Part Number
Dual Dispenser, 36"	A1	W03014-G1
	B1	W02978-G1
Dual Pump, 36" (obsolete, see note 1)	A1	W03014-G2
	B1	W02978-G2
MPD Dispenser, 48" (obsolete, see notes 2 and 3)	A1	W03051-G1
	B1	W03054-G1
Notes: 1. W03014-G2 is obsolete and no replacement. 2. W03051-G1 is obsolete and no replacement. 3. W03054-G1 is obsolete and no replacement.		

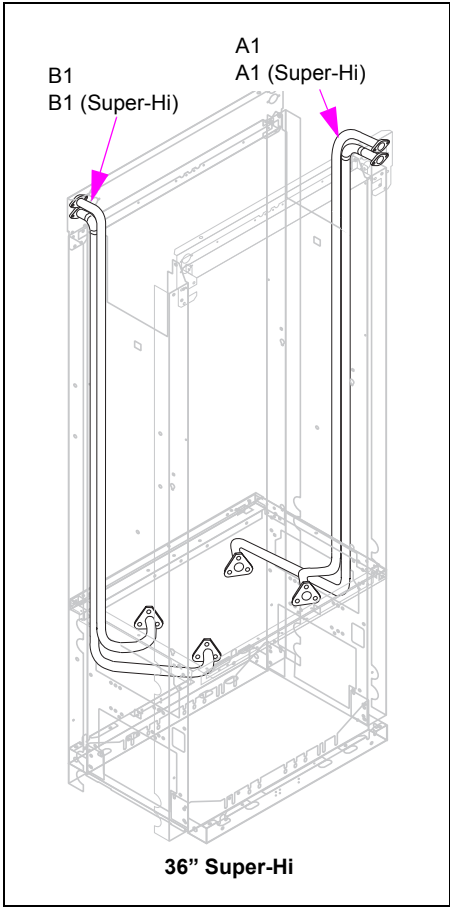

Unit	Discharge Line	Part Number
36" Super-Hi Dispenser	A1, B1	W02978-G1
	A1, B1 (Super-Hi)	W03670-G1
Note: W03670-G1 is obsolete and no replacement.		

Two-grade, Four-hose Units

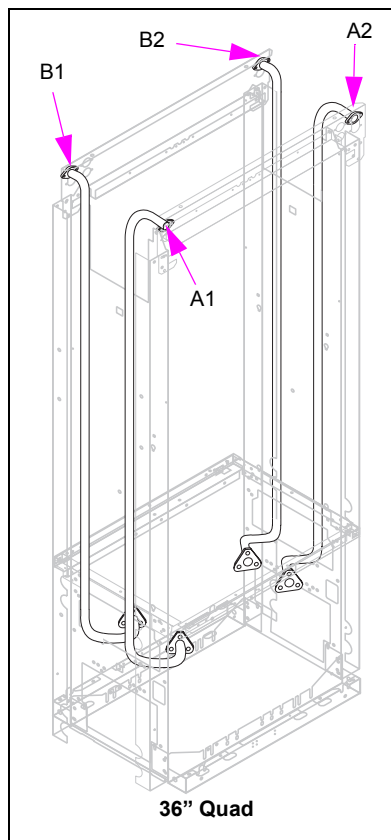

Unit	Discharge Line	Part Number
36" Quad Dispenser	A1, B2	W02979-G1
	A2, B1	W02978-G1
36" Quad Pump	A1, B2	W02979-G2
	A2, B1	W02978-G2

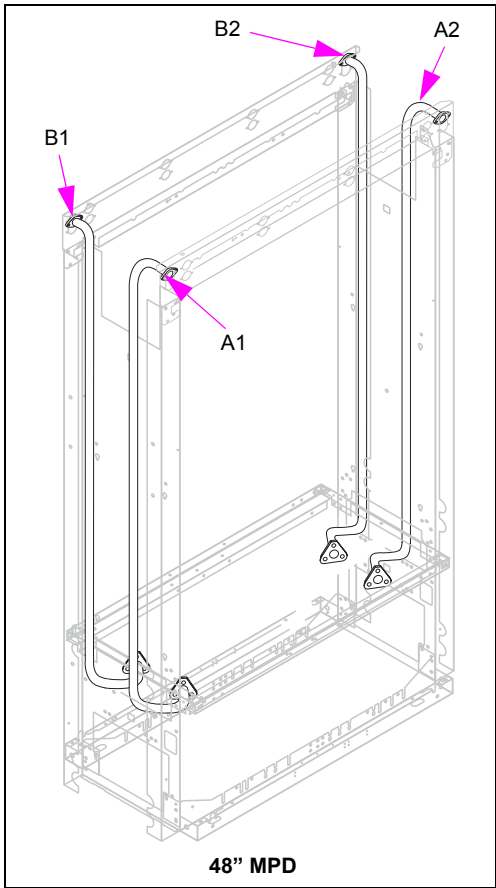

Unit	Discharge Line	Part Number
48" MPD Dispenser	A1, B2	W02979-G1
	A2, B1	W02978-G1
48" MPD Pump	A1, B2	W02979-G2
	A2, B1	W02978-G2

Three-grade, Six-hose Units

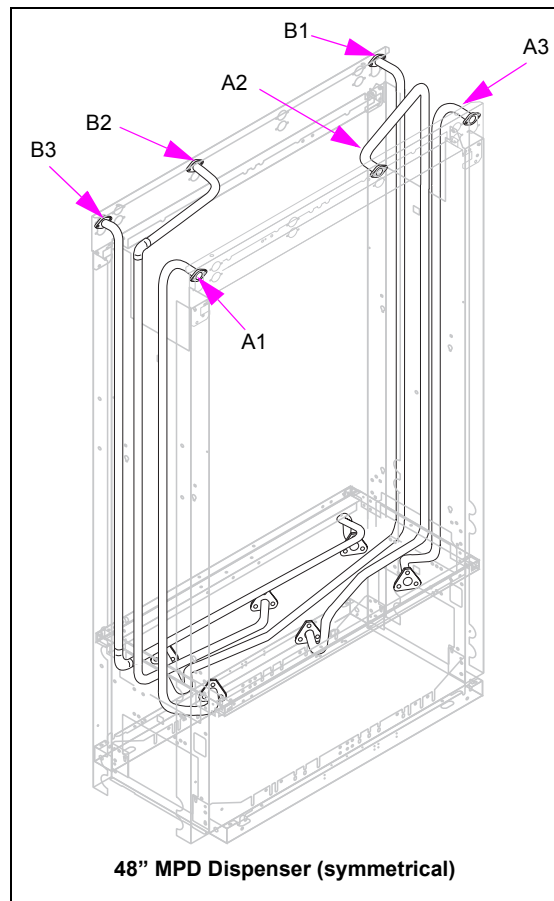

Unit	Discharge Line	Part Number
48" MPD Dispenser (symmetrical) (obsolete, see notes 1 and 2)	A1	W02979-G1
	A2	W02977-G1
	A3	W02978-G1
	B1	W03621-G1
	B2	W02976-G1
	B3	W03622-G1
Notes: 1. W02979-G1 is obsolete and no replacement. 2. W03621-G1 is obsolete and no replacement.		

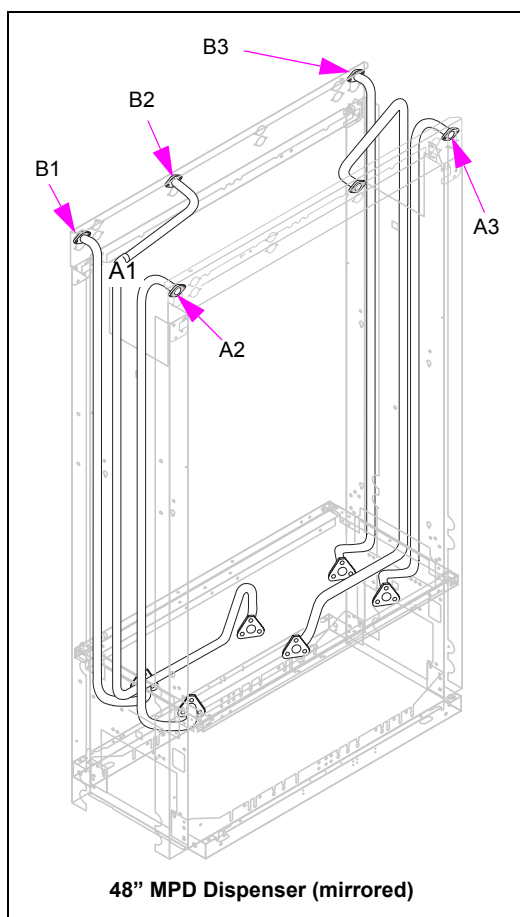

Unit	Discharge Line	Part Number
48" MPD Dispenser (mirrored)	A1, B3	W02979-G1
	A2	W02977-G1
	A3, B1	W02978-G1
	B2	W02976-G1
48" MPD Pump (mirrored) (obsolete, see notes 1 and 2)	A1, B3	W02979-G2
	A2	W03070-G1
	A3, B1	W02978-G2
	B2	W03071-G1
Notes: 1. W03070-G1 is obsolete and no replacement. 2. W03071-G1 is obsolete and no replacement.		

Four-grade, Eight-hose Units

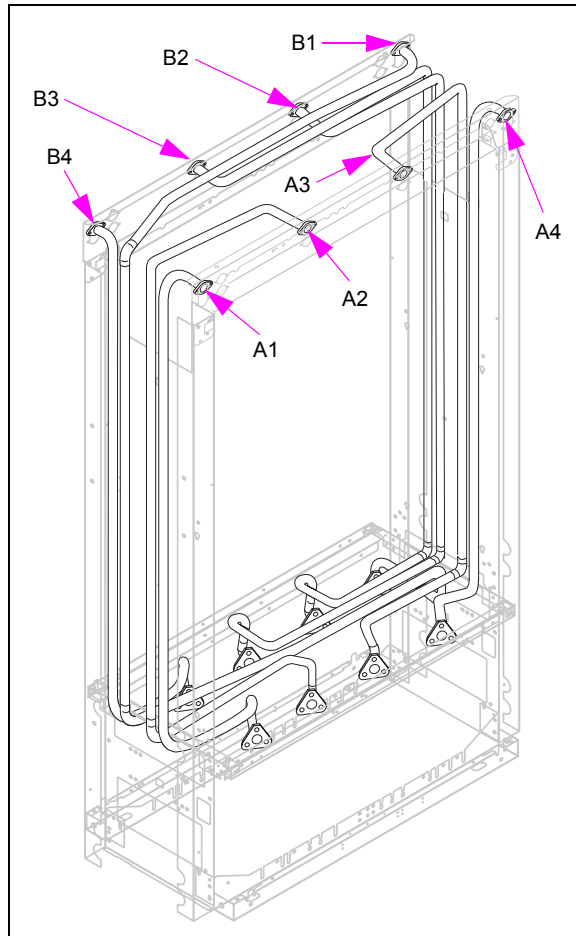

Unit	Discharge Line	Part Number
48" MPD Dispenser (symmetrical) (obsolete, see notes 1, 2, 3, 4, and 5)	A1	W03051-G1
	A2	W03052-G1
	A3	W03053-G1
	A4	W02978-G1
	B1	W03611-G1
	B2	W03609-G1
	B3	W03610-G1
	B4	W03608-G1
Notes: 1. W03051-G1 is obsolete and no replacement. 2. W03608-G1 is obsolete and no replacement. 3. W03609-G1 is obsolete and no replacement. 4. W03610-G1 is obsolete and no replacement. 5. W03611-G1 is obsolete and no replacement.		

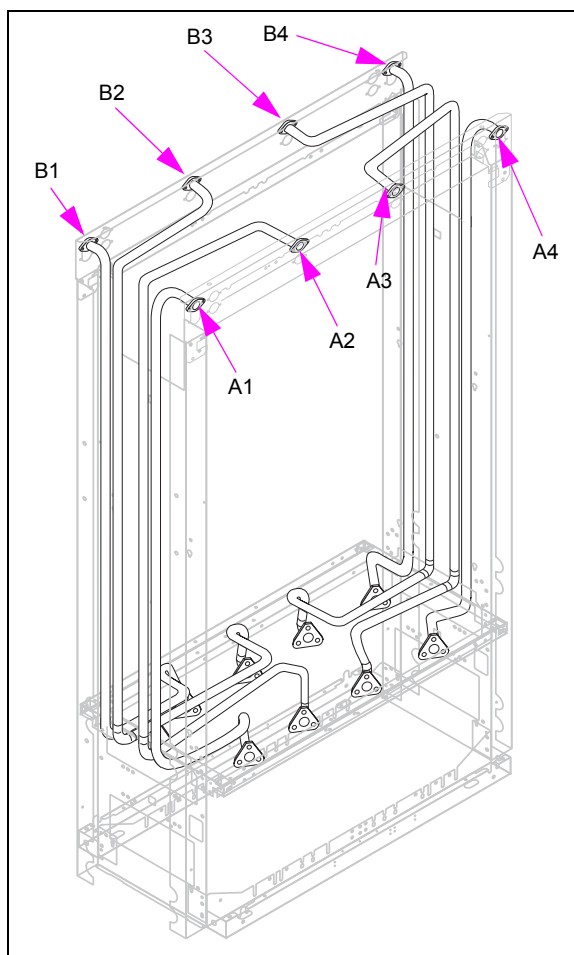

Unit	Discharge Line	Part Number
48" MPD Dispenser (mirrored) (obsolete, see notes 1, 2, 3, and 4)	A1	W03051-G1
	A2	W03052-G1
	A3	W03053-G1
	A4	W02978-G1
	B1	W03054-G1
	B2	W03055-G1
	B3	W03056-G1
	B4	W02979-G1
Notes: 1. W02979-G1 is obsolete and no replacement. 2. W03051-G1 is obsolete and no replacement. 3. W03054-G1 is obsolete and no replacement. 4. W03056-G1 is obsolete and no replacement.		

36-inch Blenders

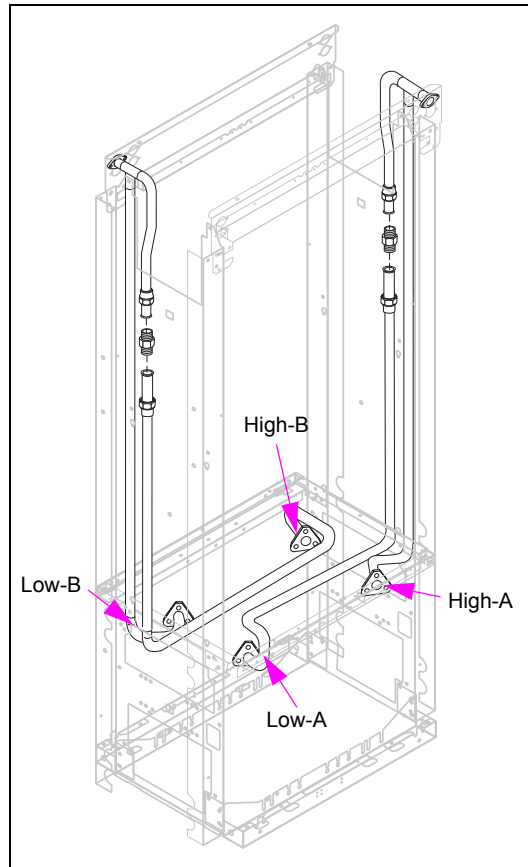

Unit	Discharge Line	Part Number
36" Blender Dispenser	Low-A, High-B	W03057-G1
	High-A, Low-B	W03045-G1
	Flare Union (quantity of 2)	Q12625-01

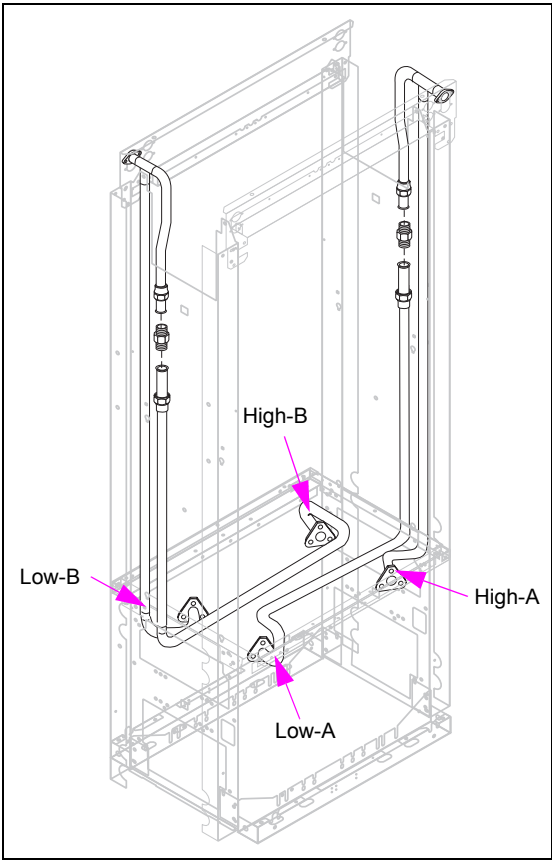

Unit	Discharge Line	Part Number
36" Blender Pump	Low-A, High-B	W03057-G2
	High-A, Low-B	W03045-G2
	Flare union (quantity of 2)	Q12625-01

MPD, 48-inch, Three-grade, Single-hose Dispenser

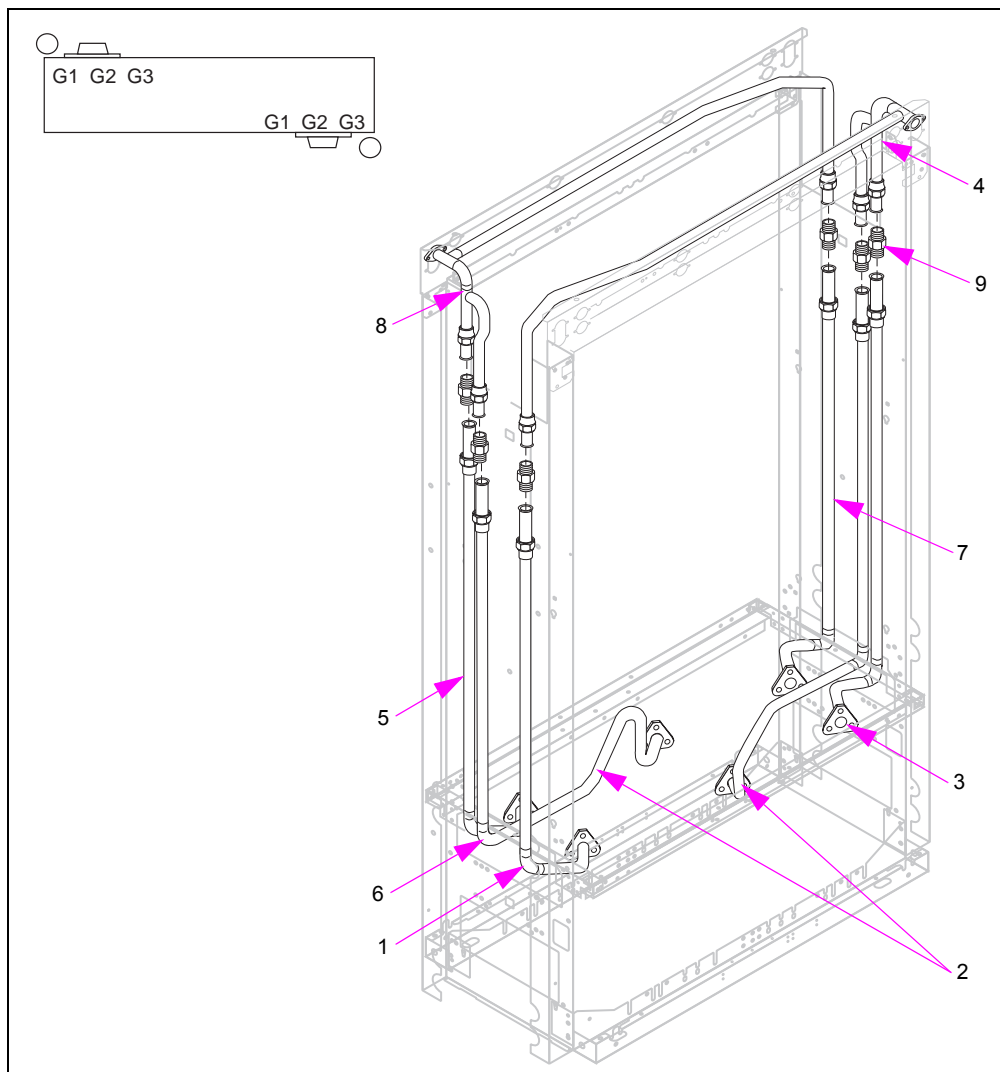

Item #	Part Description	Current Part	Previous Part	Quantity
1	Discharge Line A1	W02902-G1	-	1
2	Discharge Line A2	W02901-G1	-	1
3	Discharge Line A3 (obsolete, see note 1)	-	W02903-G1	1
4	Top Discharge Line Assembly, Side A	W03139-G1	-	1
5	Discharge Line B1 (obsolete, see note 1)	-	W02903-G1	1
6	Discharge Line B2	W03049-G1	-	1
7	Discharge Line B3	W02902-G1	-	1
8	Top Discharge Line Assembly, Side B	W03139-G1	-	1
9	Flare Union, 7/8" (obsolete, see note 1)	-	Q12625-01	6

Notes:

1. No replacement.
2. All parts may not be available as spare parts.
3. Single-sided units use Side A piping only.

MPD, 48-inch, Three-grade, Single-hose Dispenser with Extended Reach Option

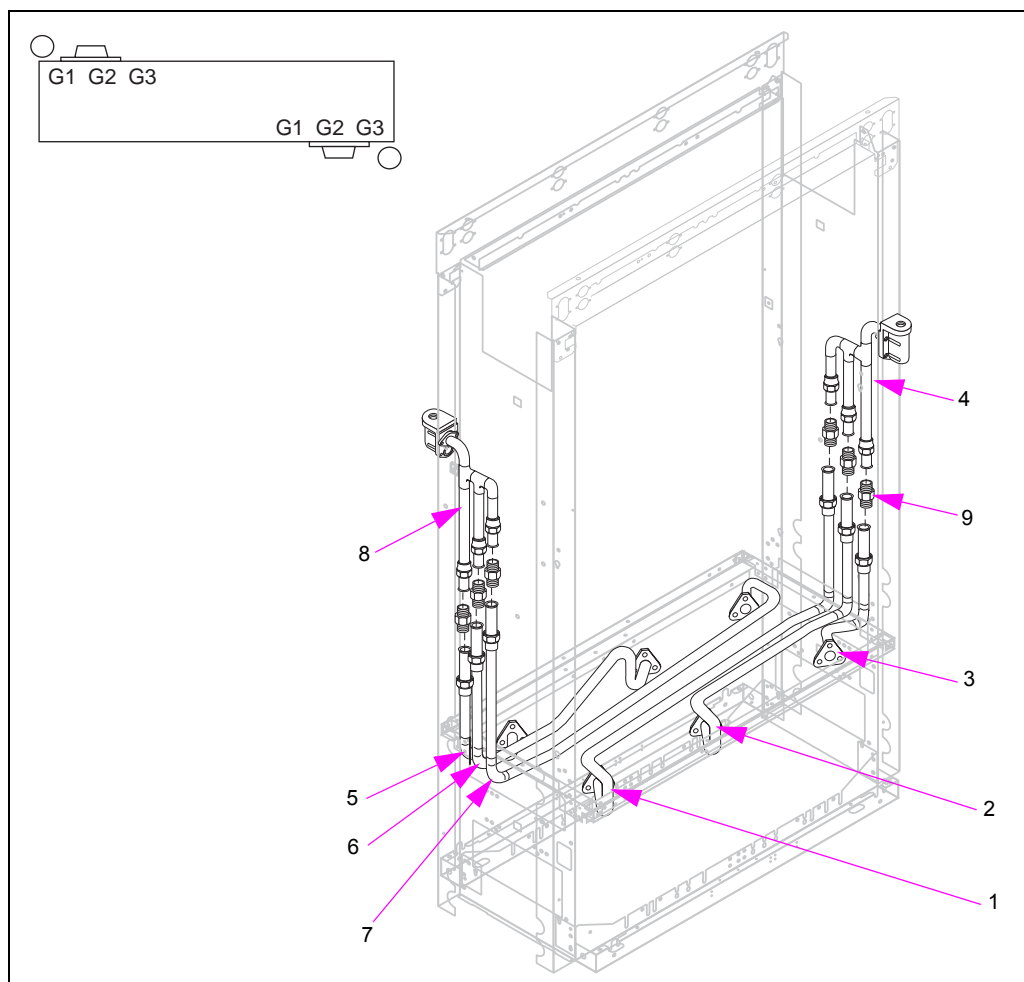

Item #	Part Description	Current Part	Previous Part	Quantity
1	Discharge Line A1 (obsolete, see note 1)	-	W03270-G1	1
2	Discharge Line A2 (obsolete, see note 1)	-	W03271-G1	1
3	Discharge Line A3 (obsolete, see note 1)	-	W03273-G1	1
4	Top Discharge Line Assembly, Side A (obsolete, see note 1)	-	T19057-G1	1
5	Discharge line B1 (obsolete, see note 1)	-	W03273-G1	1
6	Discharge line B2 (obsolete, see note 1)	-	W03272-G1	1
7	Discharge line B3 (obsolete, see note 1)	-	W03270-G1	1
8	Top Discharge Line Assembly, Side B (obsolete, see note 1)	-	T19057-G1	1
9	Flare Union, 7/8"	Q12625-01	-	6
Notes: 1. No replacement. 2. All parts may not be available as spare parts. 3. Single-sided units use Side A piping only.				

MPD, 48-inch, Four-grade, Single-hose + 1 Dispenser

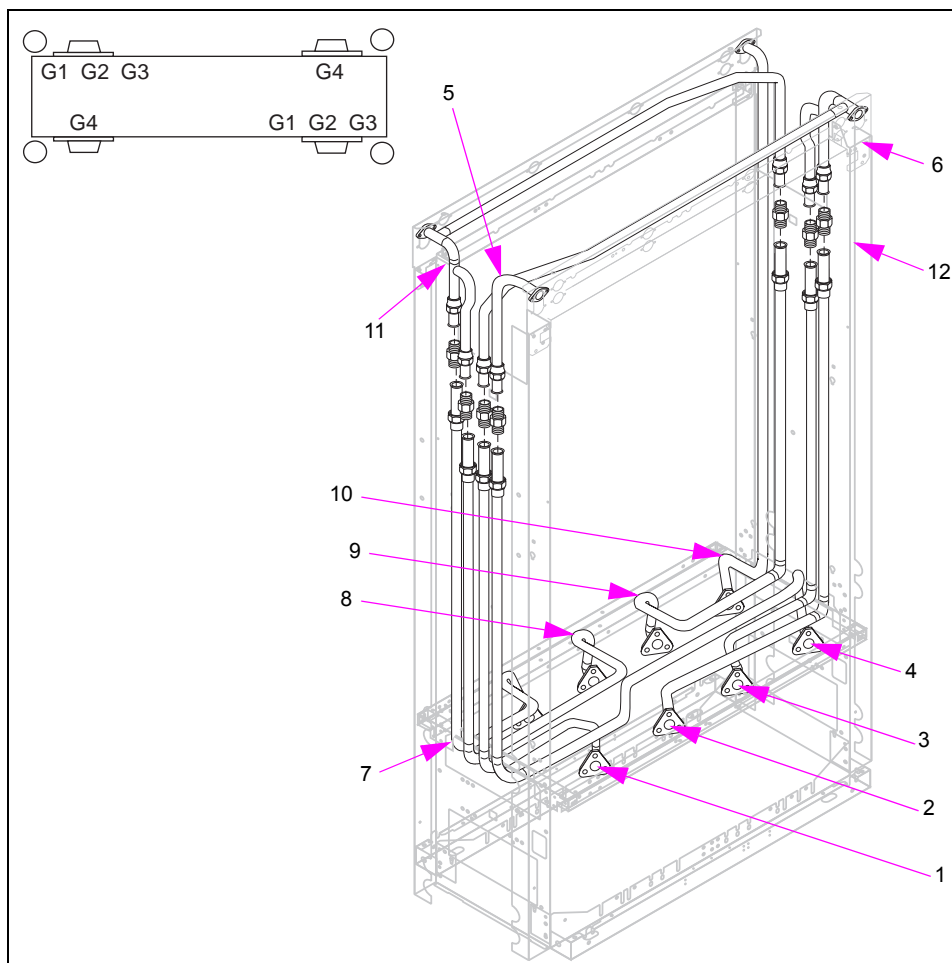

Item #	Part Description	Current Part	Previous Part	Quantity
1	Discharge Line A1 (obsolete, see note 1)	-	W03468-G1	1
2	Discharge Line A2	W03469-G1	-	1
3	Discharge Line A3 (obsolete, see note 1)	-	W03470-G1	1
4	Discharge Line A4 (obsolete, see note 1)	-	W03471-G1	1
5	Upper Discharge Line A4	T19458-G1	-	1
6	Top Discharge Line Assembly, Side A (obsolete, see note 1)	-	W03467-G1	1
7	Discharge Line B1	W03472-G1	-	1
8	Discharge Line B2 (obsolete, see note 1)	-	W03473-G1	1
9	Discharge Line B3	W03474-G1	-	1
10	Discharge Line B4	W02979-G1	-	1
11	Top Discharge Line Assembly, side B (obsolete, see note 1)	-	W03467-G1	1
12	Flare Union, 7/8"	Q12625-01	-	7

Notes:

1. No replacement.
2. All parts may not be available as spare parts.
3. Single-sided units use Side A piping only

Blender, 48-inch, Six-hose Dispenser

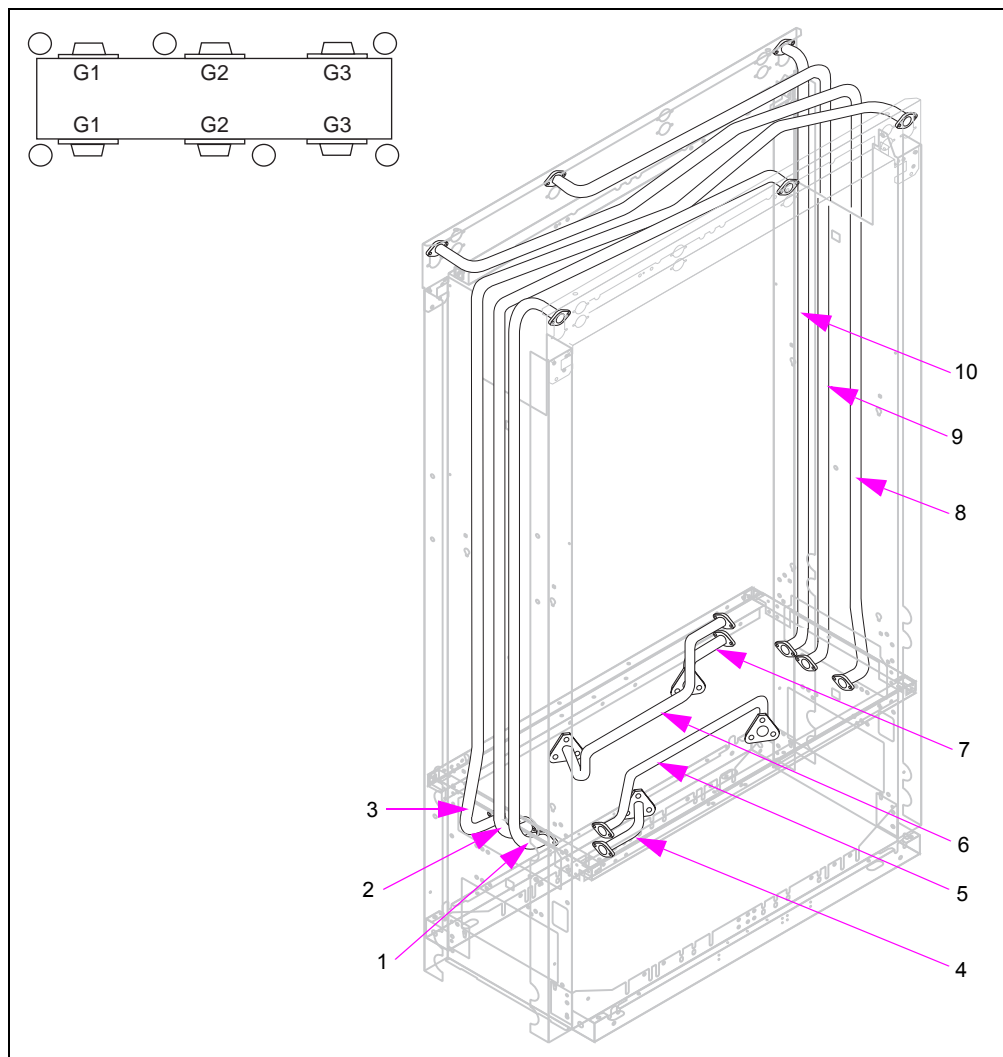

Item #	Part Description	Current Part	Previous Part	Quantity
1	Discharge Line A1 (obsolete, see note 1)	-	W02996-G1	1
2	Discharge Line A2 (obsolete, see note 1)	-	W02997-G1	1
3	Discharge Line A3 (obsolete, see note 1)	-	W03152-G1	1
4	Feed Line, Side A, Low Product (obsolete, see note 1)	-	T18814-G1	1
5	Feed Line, Side A, High Product (obsolete, see note 1)	-	W02995-G1	1
6	Feed Line, Side B, Low Product (obsolete, see note 1)	-	W02995-G1	1
7	Feed Line, Side B, High Product (obsolete, see note 1)	-	T18814-G1	1
8	Discharge Line B1 (obsolete, see note 1)	-	W03152-G1	1
9	Discharge Line B2 (obsolete, see note 1)	-	W02997-G1	1
10	Discharge Line B3 (obsolete, see note 1)	-	W02996-G1	1

Notes:

1. No replacement.
2. Single-sided units use Side A piping only.
3. All parts may not be available as spare parts.

Blender, 48-inch, X + 0 Dispenser (Mirrored)

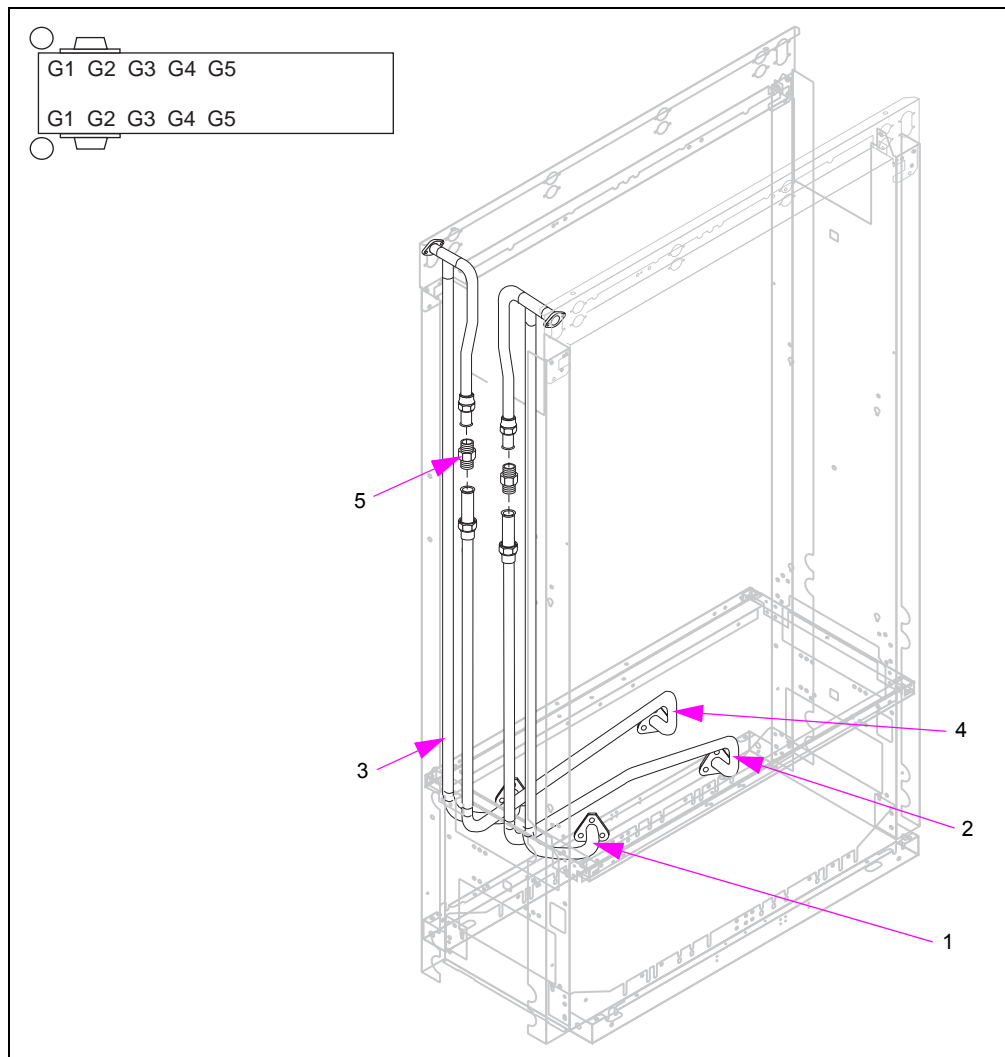

Item #	Part Description	Current Part	Previous Part	Quantity
1	Discharge Line, Side A, Low Product	W03043-G1	-	1
2	Discharge Line, Side A, High Product	W03047-G1	-	1
3	Discharge Line, Side B, Low Product	W03045-G1	-	1
4	Discharge Line, Side B, High Product	W03049-G1	-	1
5	Flare Union, 7/8"	Q12625-01	-	2
Notes: 1. Single-sided units use Side A piping only. 2. All parts may not be available as spare parts.				

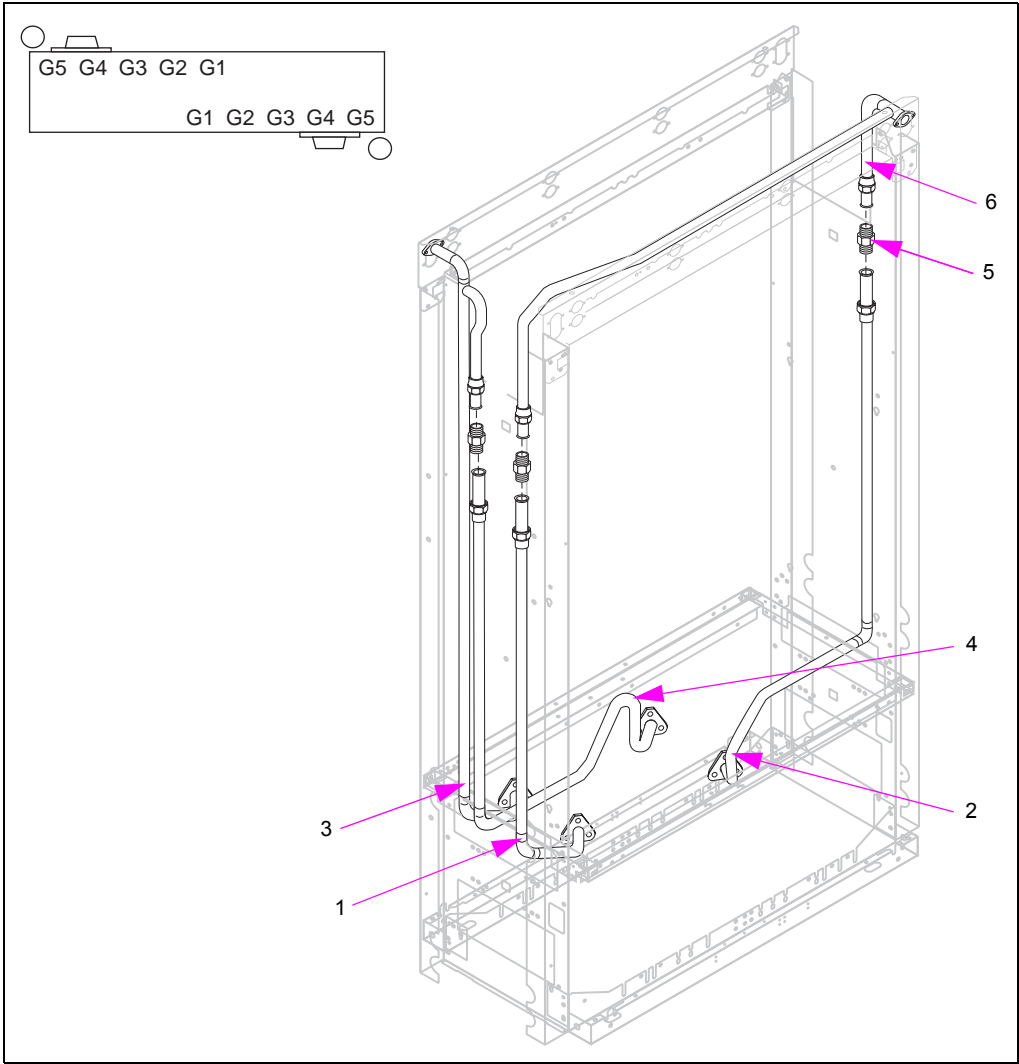

Item #	Part Description	Current Part	Previous Part	Quantity
1	Discharge Line, Side A, Low Product	W02902-G1	-	1
2	Discharge Line, Side A, High Product	W02901-G1	-	1
3	Discharge Line, Side B, Low Product	W03045-G1	-	1
4	Discharge Line, Side B, High Product	W03049-G1	-	1
5	Flare Union, 7/8"	Q12625-01	-	3
6	Upper Discharge Line, Side A	W03512-G1	-	1
Notes: 1. Single-sided units use Side A piping only. 2. All parts may not be available as spare parts.				

Blender, 48-inch, X + 0 Dispenser (Symmetrical, Hose Left)

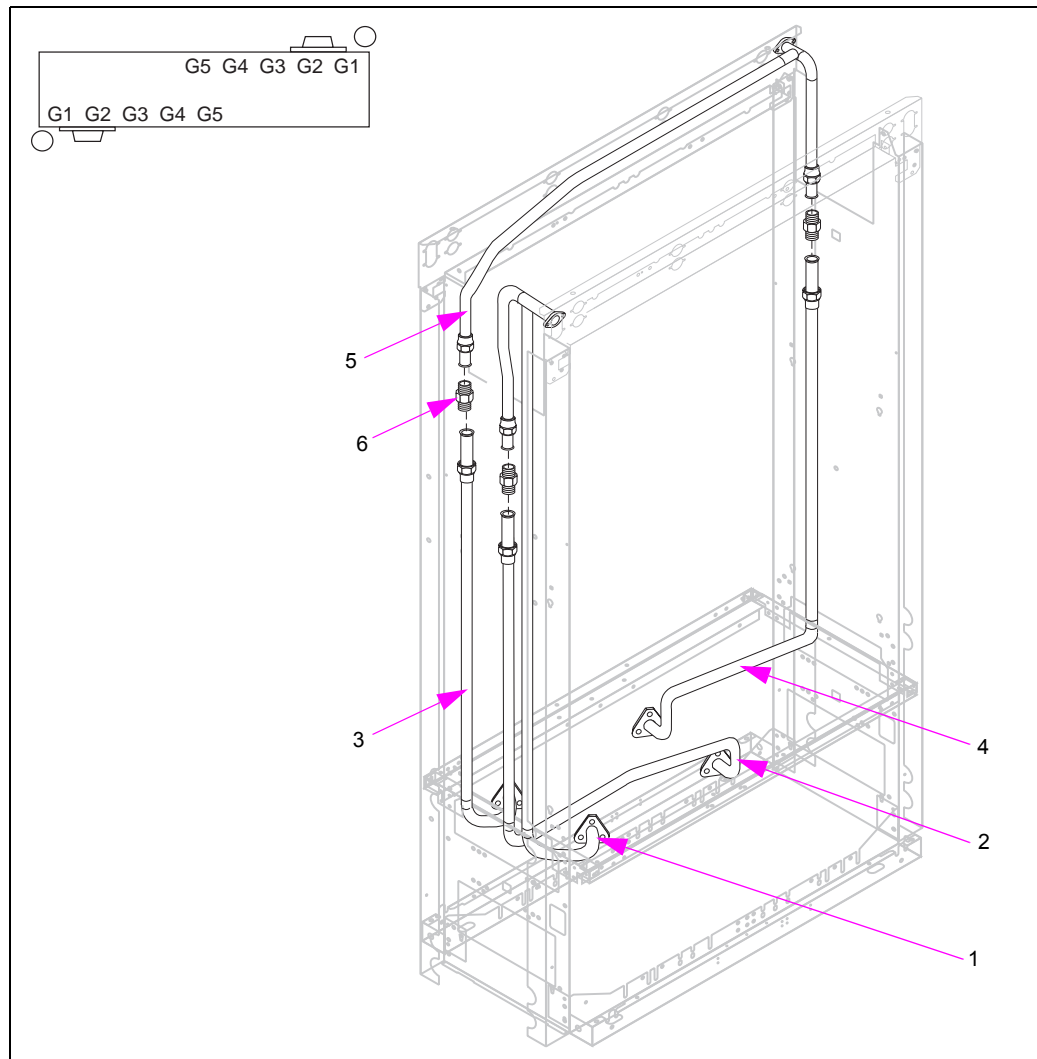

Item #	Part Description	Current Part	Previous Part	Quantity
1	Discharge Line, Side A, Low Product	W03043-G1	-	1
2	Discharge Line, Side A, High Product	W03047-G1	-	1
3	Discharge Line, Side B, Low Product (obsolete, see note 1)	-	W02903-G1	1
4	Discharge Line, Side A, High Product	W03383-G1	-	1
5	Upper Discharge Line, Side B	W03382-G1	-	1
6	Flare Union, 7/8"	Q12625-01	-	3
Notes: 1. No replacement. 2. All parts may not be available as spare parts. 3. Single-sided units use Side A piping only.				

Blender, 48-inch, X + 0 Dispenser (Symmetrical, with Extended Reach Option)

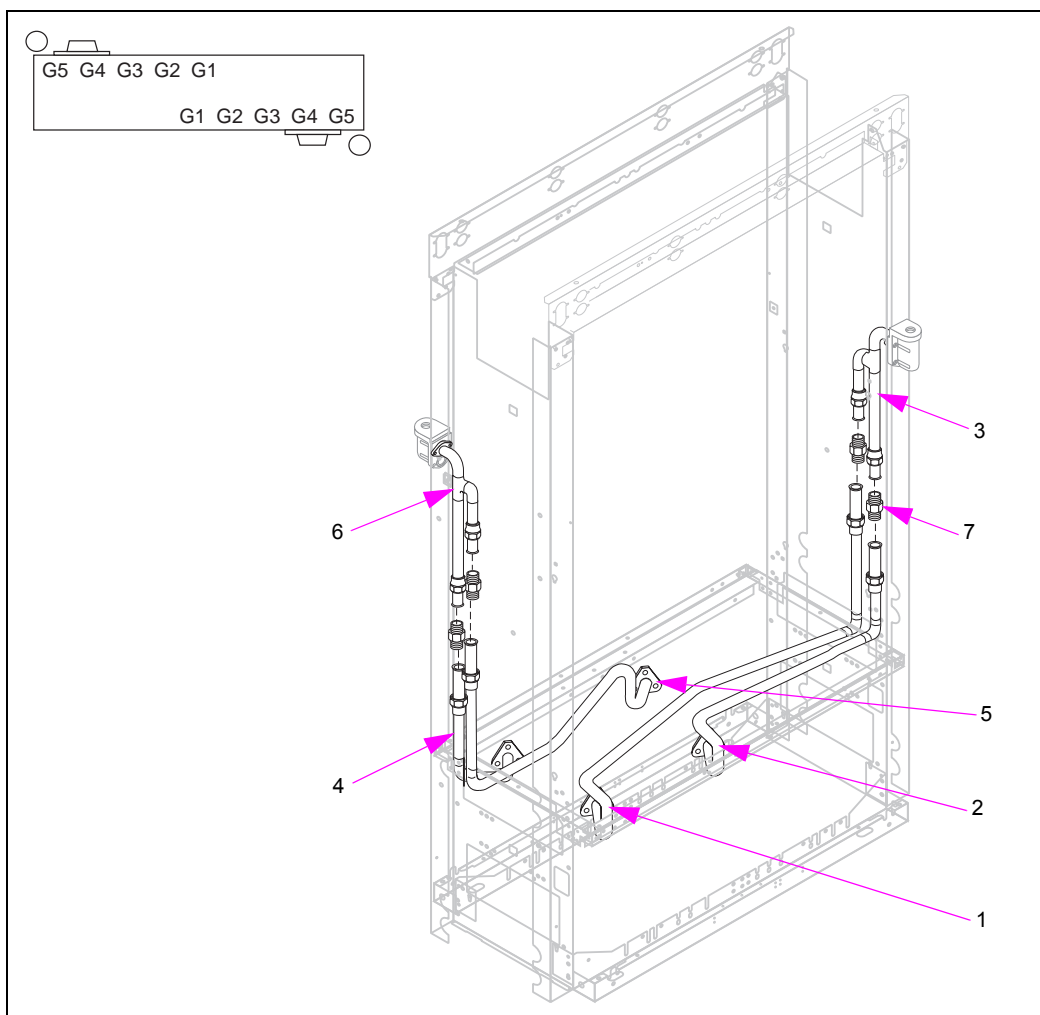

Item #	Part Description	Current Part	Previous Part	Quantity
1	Discharge Line, Side A, Low Product	W03711-G1	W03561-G1	1
2	Discharge Line, Side A, High Product (obsolete, see note 1)	-	W03562-G1	1
3	Upper Discharge Line, Side A (obsolete, see note 1)	-	T19647-G1	1
4	Discharge Line, Side B, Low Product (obsolete, see note 1)	-	W03559-G1	1
5	Discharge Line, Side A, High Product (obsolete, see note 1)	-	W03560-G1	1
6	Upper Discharge Line, Side B (obsolete, see note 1)	-	T19647-G1	1
7	Flare Union, 7/8"	Q12625-01	-	3
Notes: 1. No replacement. 2. All parts may not be available as spare parts. 3. Single-sided units use Side A piping only.				

Blender, 48-inch, X + 1 Dispenser (Mirrored)

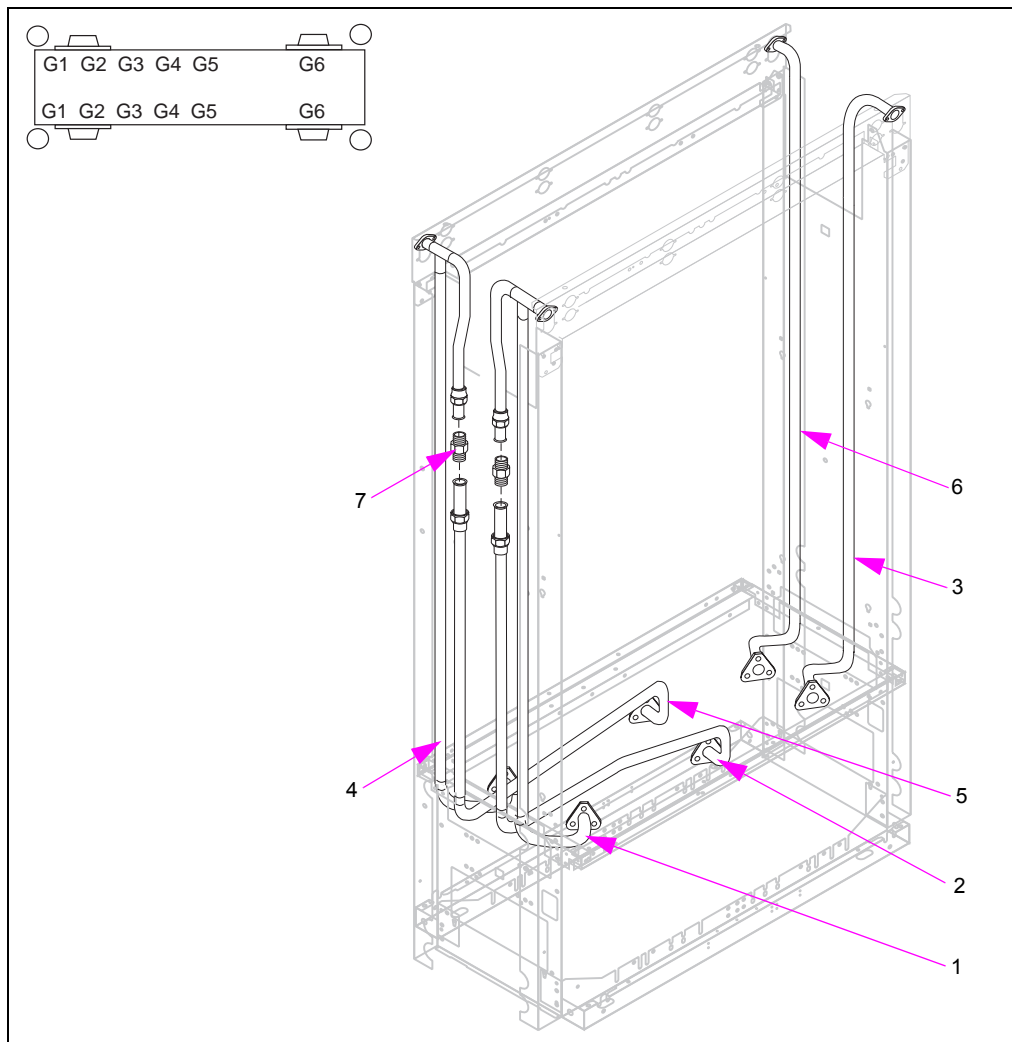

Item #	Part Description	Current Part	Previous Part	Quantity
1	Discharge Line, Side A, Low Product	W03043-G1	-	1
2	Discharge Line, Side A, High Product	W03047-G1	-	1
3	Discharge Line, Side A, Straight Product	W02978-G1	-	1
4	Discharge Line, Side B, Low Product	W03045-G1	-	1
5	Discharge Line, Side B, High Product	W03049-G1	-	1
6	Discharge Line, Side B, Straight Product	W02979-G1	-	1
7	Flare Union, 7/8"	Q12625-01	-	2

Notes:

1. Single-sided units use Side A piping only.
2. All parts may not be available as spare parts.

Blender, 48-inch, X + 1 Dispenser (Symmetrical, Straight-product Right)

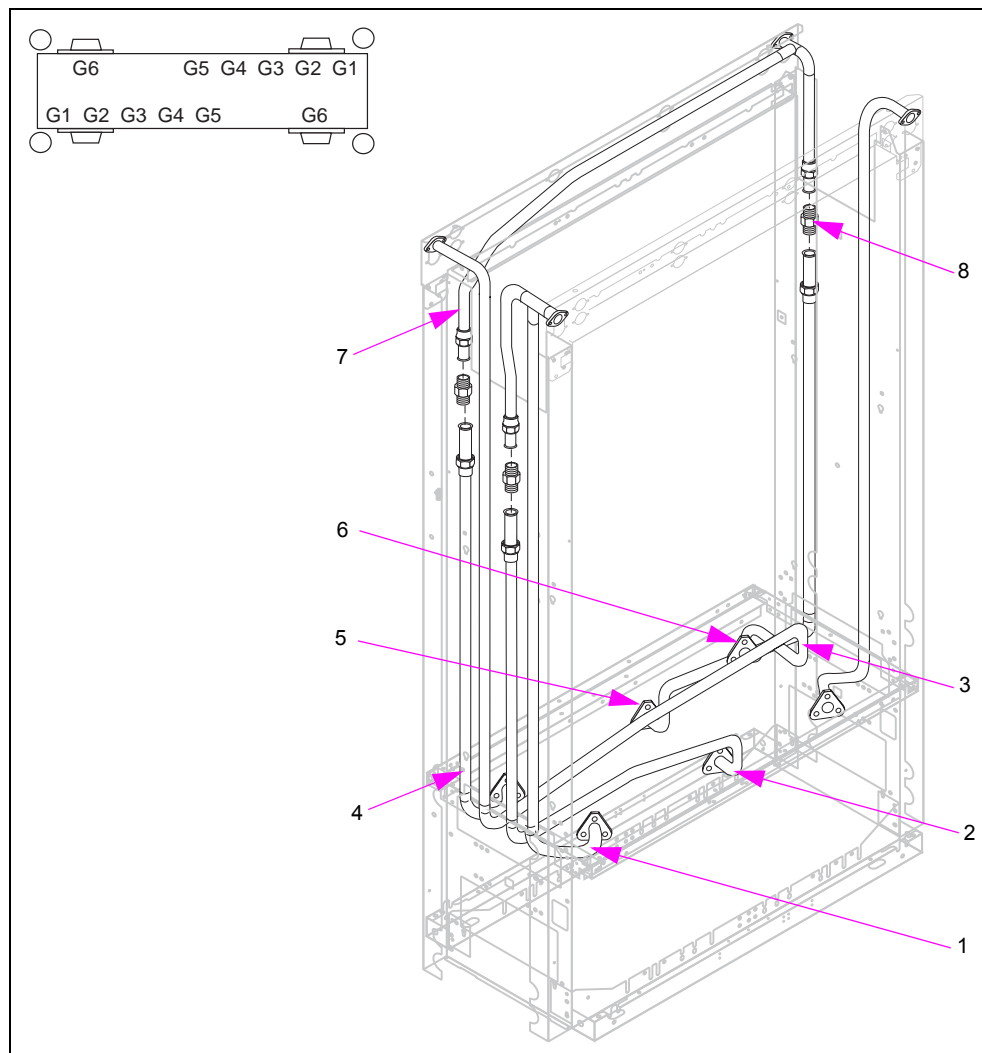

Item #	Part Description	Current Part	Previous Part	Quantity
1	Discharge Line, Side A, Low Product	W03043-G1	-	1
2	Discharge Line, Side A, High Product	W03047-G1	-	1
3	Discharge Line, Side A, Straight Product	W02978-G1	-	1
4	Discharge Line, Side B, Low Product (obsolete, see note 1)	-	W02903-G1	1
5	Discharge Line, Side B, High Product	W03383-G1	-	1
6	Discharge Line, Side B, Straight Product	W03587-G1	-	1
7	Upper Discharge Line, Side B	W03382-G1	-	1
8	Flare Union, 7/8"	Q12625-01	-	3

Notes:

- No replacement.
- All parts may not be available as spare parts.
- Single-sided units use Side A piping only.

Blender, 48-inch, X + 1 Dispenser (Symmetrical, Straight-product Left)

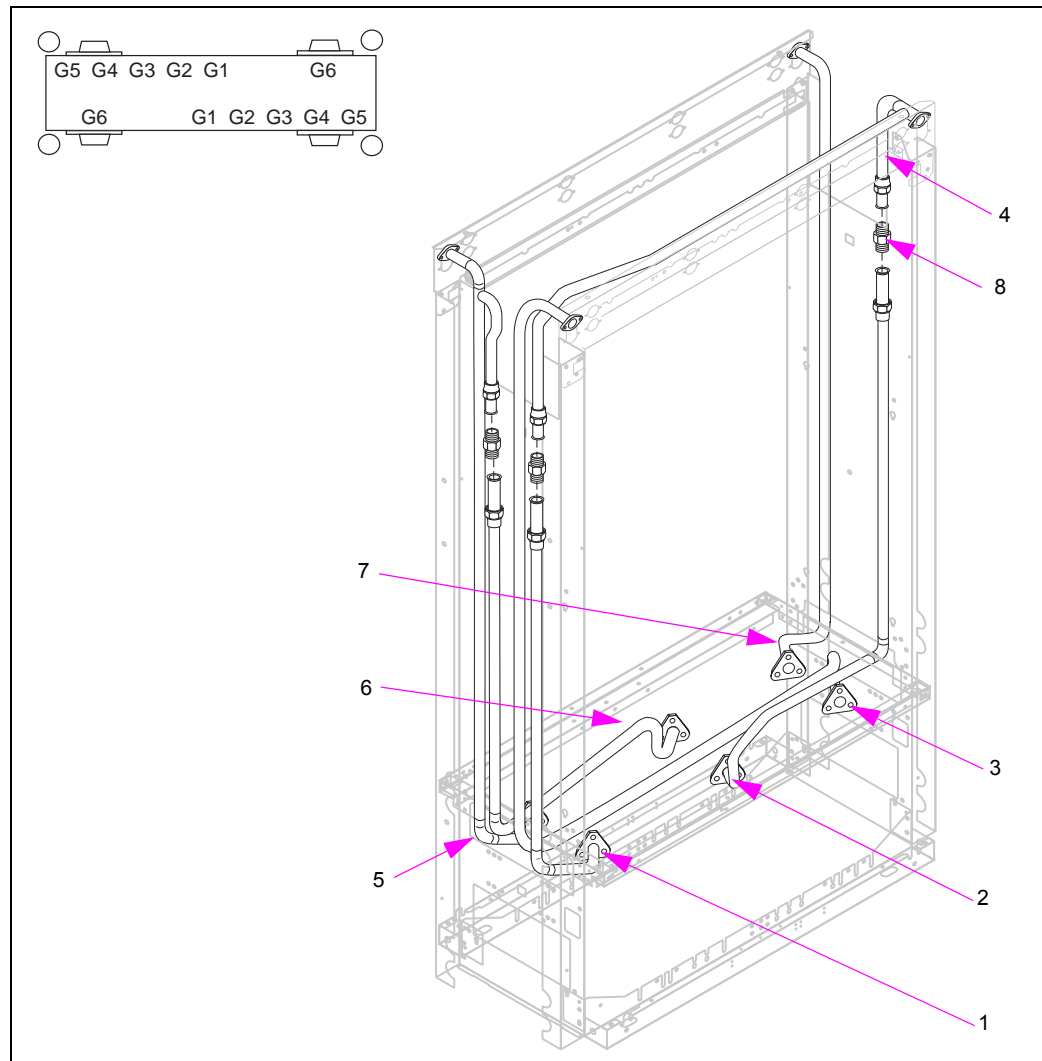

Item #	Part Description	Current Part	Previous Part	Quantity
1	Discharge Line, Side A, Low Product	W02902-G1	-	1
2	Discharge Line, Side A, High Product	W02901-G1	-	1
3	Discharge Line, Side A, Straight Product	W03590-G1	-	1
4	Upper Discharge Line, Side A	W03512-G1	-	1
5	Discharge Line, Side B, Low Product	W03045-G1	-	1
6	Discharge Line, Side B, High Product	W03049-G1	-	1
7	Discharge Line, Side B, Straight Product	W02979-G1	-	1
8	Flare Union, 7/8"	Q12625-01	-	3
Notes: 1. Single-sided units use Side A piping only. 2. All parts may not be available as spare parts.				