



# Cim-Tek® Filtration ADAPTORS

## 3/4" NPT Inlet/Outlet Ports

Part No.

Adaptor

Description

Dimensions

50003



Material: Cast-iron adaptor  
Used on: 200E, 250E, 260, & 300 series  
Inlet/Outlet ports: 3/4" NPT  
Nose outside thread: 1"-12 UNF

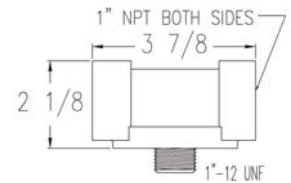

50181



Material: Aluminum adaptor  
Used on: 200E, 250E, 260, & 300 series  
Inlet/Outlet ports: 3/4" NPT  
Nose outside thread: 1"-12 UNF

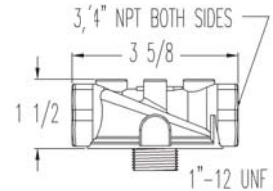

## 1" NPT Inlet/Outlet Ports

Part No.

Adaptor

Description

Dimensions

50002



Material: Cast-iron adaptor  
Used on: 200E, 250E, 260, & 300 series  
Inlet/Outlet ports: 1" NPT  
Nose outside thread: 1"-12 UNF

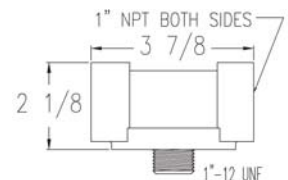

50004



Material: Cast-iron adaptor  
Used on: 200AE & 250AE series  
Inlet/Outlet ports: 1" NPT  
Nose outside thread: 1 3/8"-12 UNF

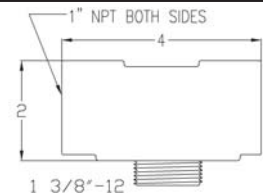

50026



Material: Aluminum adaptor-gauge ports  
Used on: 800 series  
Inlet/Outlet ports: 1" NPT  
Nose outside thread: 1"-12 UNF

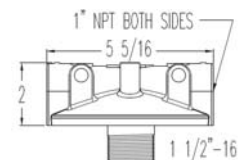

50032



Material: Aluminum adaptor  
Used on: 400, 450, & 475 series  
Inlet/Outlet ports: 1" NPT  
Nose outside thread: 1 1/2"-16 UNF

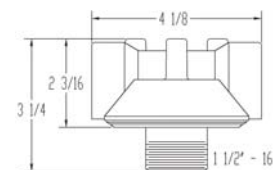

**Part No.****50109****Adaptor****Description**

Material: Aluminum adaptor  
 Used on: 800 series  
 Inlet/Outlet ports: 1" NPT  
 Nose outside thread: 1 1/2"-16 UNF

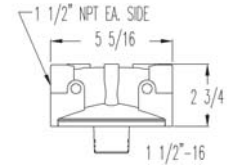
**Dimensions****1 1/2" NPT Inlet/Outlet Ports****Part No.****50015****Adaptor****Description**

Material: Cast-iron adaptor  
 Used on: 200E, 250E, 260, & 300 series  
 Inlet/Outlet ports: 1 1/2" NPT  
 Nose outside thread: 1"-12 UNF

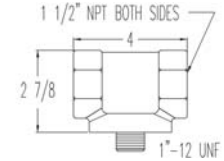
**Dimensions****50005**

Material: Aluminum adaptor  
 Used on: 200E, 250E, 260, & 300 series  
 Inlet/Outlet ports: 1 1/2" NPT  
 Nose outside thread: 1"-12 UNF

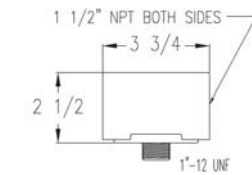
**50027**

Material: Aluminum adaptor-gauge ports  
 Used on: 800 series  
 Inlet/Outlet ports: 1 1/2" NPT  
 Nose outside thread: 1 1/2"-16 UNF

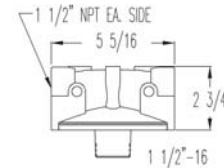
**50163**

Material: Aluminum adaptor  
 Used on: 800 series  
 Inlet/Outlet ports: 1 1/2" NPT  
 Nose outside thread: 1 1/2"-16 UNF

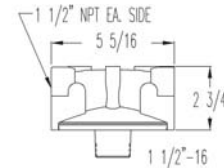
**50006**

Material: Aluminum dual adaptor  
 Used on: 200E, 250E, 260, & 300 series  
 Inlet/Outlet ports: 1 1/2" NPT  
 Nose outside thread: 1"-12 UNF

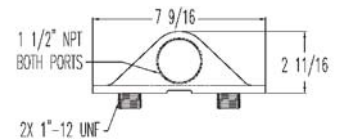
**2" NPT Inlet/Outlet Ports****Part No.****50011****Adaptor****Description**



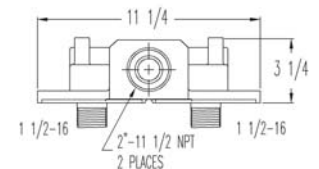



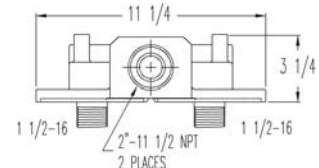

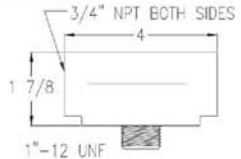

Material: Aluminum dual adaptor  
 Used on: 800 series  
 Inlet/Outlet ports: 2" NPT  
 Nose outside thread: 1 1/2"-16 UNF

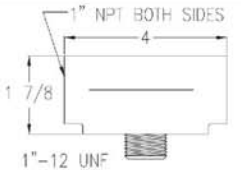
**Dimensions****50028**

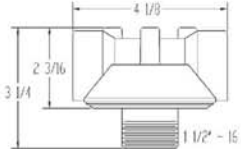
Material: Aluminum dual adaptor-gauge ports  
 Used on: 800 series  
 Inlet/Outlet ports: 2" NPT  
 Nose outside thread: 1 1/2"-16 UNF

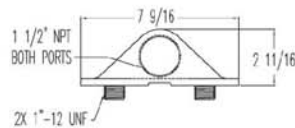

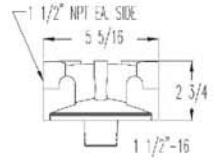
# Adaptors for High Bio-Content

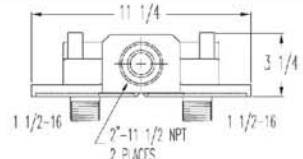
Part No.	Adaptor	Description	Dimensions
50017N		Material: Nickel-plated adaptor Used on: Part #70025 Inlet/Outlet ports: 3/4" NPT Nose outside thread: 1"-12 UNF	
50016N		Material: Nickel-plated adaptor Used on: Part #70025 Inlet/Outlet ports: 1" NPT Nose outside thread: 1"-12 UNF	
50032N		Material: Nickel-plated adaptor Used on: Model #70039 Inlet/Outlet ports: 1" NPT Nose outside thread: 1 1/2"-16 UNF	
50018N		Material: Nickel-plated dual adaptor Used on: Part #70025 Inlet/Outlet ports: 1 1/2" NPT Nose outside thread: 1"-12 UNF	
50163N		Material: Nickel-plated adaptor Used on: Part #70041 Inlet/Outlet ports: 1 1/2" NPT Nose outside thread: 1 1/2"-16 UNF	
50011N		Material: Nickel-plated dual adaptor Used on: Part #70041 Inlet/Outlet ports: 2" NPT Nose outside thread: 1 1/2"-16 UNF	

## Adaptor Cap for 1"-12 UNF Thread

Part No.	Adaptor	Description	Dimensions
50001		Material: Cast-iron adaptor Used on: 200E, 250E, 260 & 300 series Nose outside thread: 1"-12 UNF	