

## 2 – Door Assembly

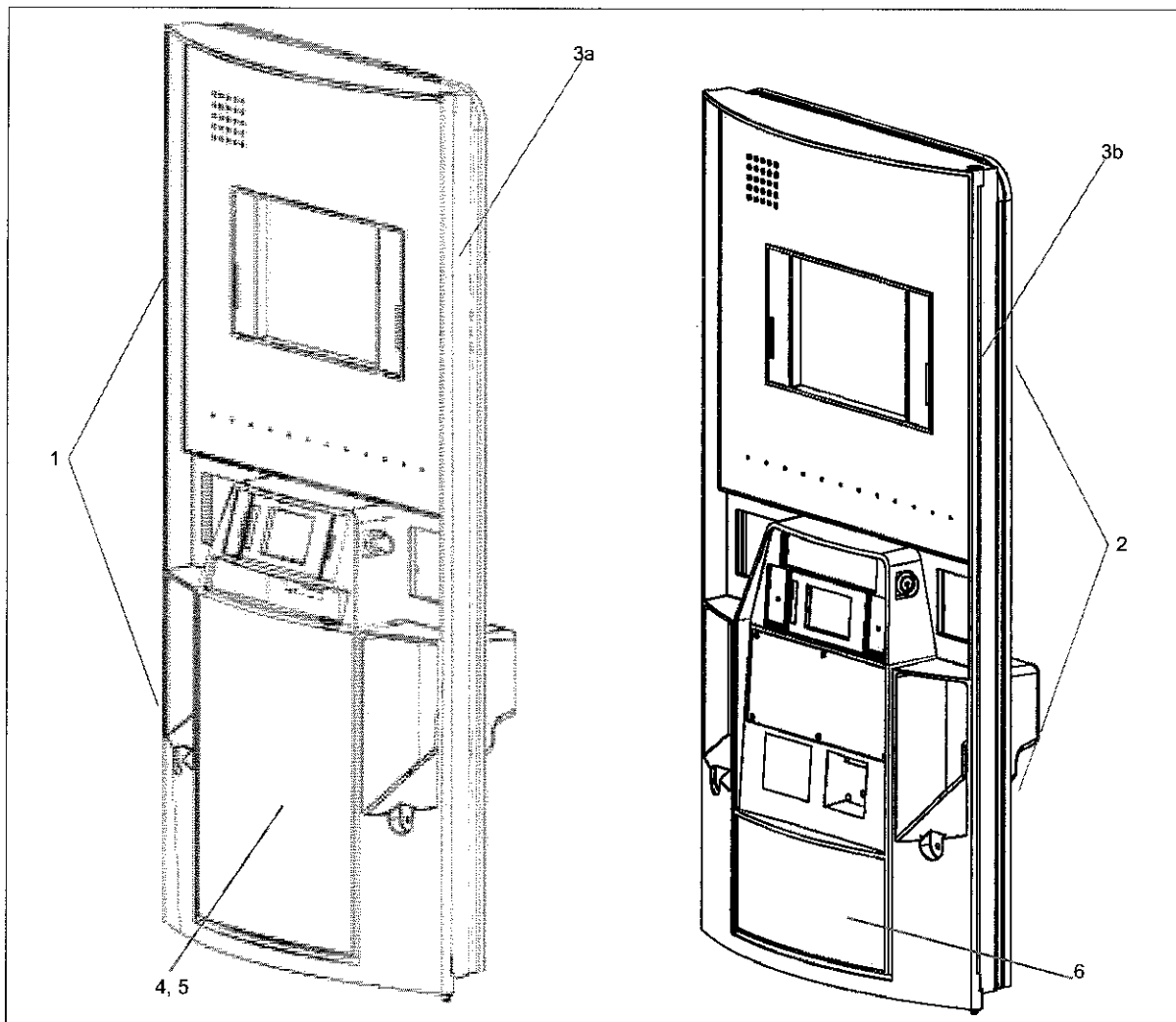

Item #	Description	Current Part	Previous Part	Quantity
1	Main Door assembly (without TRIND and call button)	M00211A001	-	1
2	Main Door assembly (with TRIND)	M00211A201	-	1
3a	• Main Panel, Display (without TRIND)	M00212B002	-	1
3b	• Main Panel, Display (with TRIND)	M00212B001	-	1
4	Oven Door Assembly, CIM, standard (See Note 1)	M00213A001	-	1
5	Oven Door Assembly, CIM, with call button (See Note 1)	M00213A002	-	1
6	Oven Door Assembly	M01509A001	-	1

**Note:**

1. Items 4 and 5 are obsolete and replaced by item 6, M01509A001.

# Door Assembly with Nozzle Boot and Blanking Panel

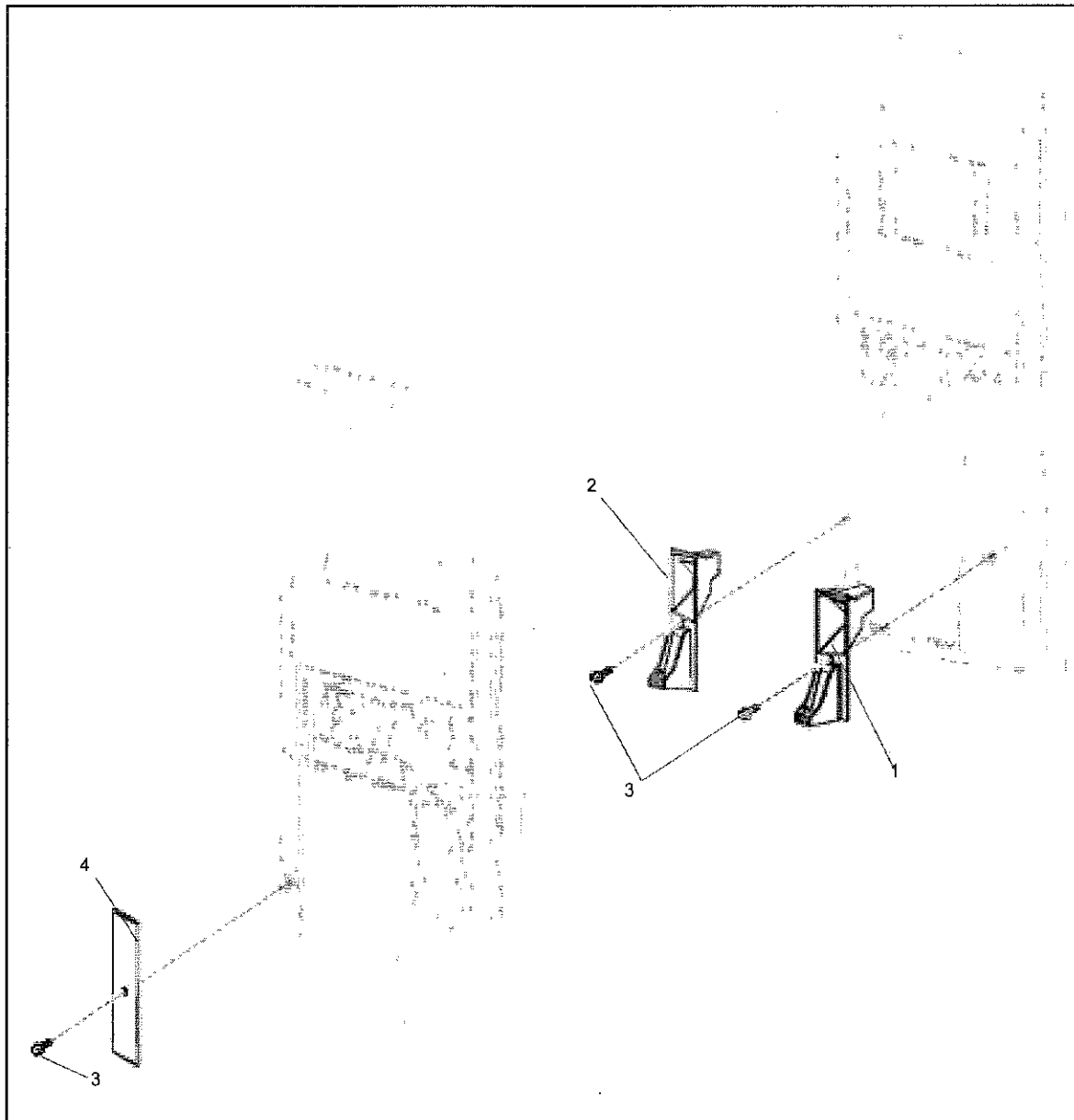

Item #	Description	Current Part	Previous Part	Quantity
1	Nozzle Boot Assembly (right)	M01426A001	-	1
2	Nozzle Boot Assembly (left)	M01427A001	-	1
3	• Screw, Hex Head, Stainless steel	-	-	1 per boot
4	Blanking Panel, Boot (left)	M00220B010	-	1
<i>Not Shown:</i>				
-	Actuator, Auto-ON flap (Used on left nozzle boot M00129A001 and right nozzle boot M00130A001).	M00243A001	-	1